

TOWN OF GOLDEN BEACH, FLORIDA

RESOLUTION NO. 2463.16

A RESOLUTION OF THE TOWN COUNCIL OF THE TOWN OF GOLDEN BEACH, FLORIDA, AUTHORIZING THE RETROFIT OF THE COMMAND POST POLICE VEHICLE AND THE USE OF THE LETF TO EQUIP THE VEHICLE; PROVIDING FOR IMPLEMENTATION; PROVIDING FOR AN EFFECTIVE DATE.

WHEREAS, the Town desires to retrofit a command post that was given to the Town by a neighboring agency in order to continue to provide service to the police patrol and police protection to the residents of Golden Beach; and

WHEREAS, the costs to the Town to equip and retrofit the command post is projected to be \$59,170.00, includes: paint, fabrication, body work, TV monitor, generator and air conditioner; and

WHEREAS, the Town's Law Enforcement Trust Fund account (the "LETF") includes assets forfeited to the Town by authority of the Florida Contraband Forfeiture Act and by the Federal Asset Forfeiture Statutes; and

WHEREAS, the Town Council desires to utilize LETF funds to pay for the retrofit and equipping of the Administrative Patrol Police vehicle; and

WHEREAS, the monies contained in the LETF are the result of seized assets from both investigations by the Town's Police Department and joint investigations with other law enforcement agencies – not from tax revenue; and

WHEREAS, the Chief of Police has recommended that the \$59,170.00 cost be taken from the Town's LETF for "***other law enforcement purposes***" specifically authorized by law; and

WHEREAS, the Chief of Police certifies that this expenditure complies with § 932.7055, Florida Statutes, and / or the Federal Seizure statutes in that the funds will be used for an appropriate law enforcement purpose; and

WHEREAS, the Chief of Police certifies that the Town's LETF is not being used as a normal source of revenue for the Town Police Department; and

WHEREAS, the Chief of Police certifies that the Town's LETF was not considered in the adoption and approval of the Police Department budget; and

WHEREAS, the Town Council finds that it is in the best interest of the Town to proceed as indicated in this Resolution.

NOW, THEREFORE, BE IT RESOLVED BY THE TOWN COUNCIL OF THE TOWN OF GOLDEN BEACH, FLORIDA, AS FOLLOWS:

Section 1. Recitals Adopted. That each of the above-stated recitals is hereby adopted and confirmed.

Section 2. Purchase of Equipment and the Use of LETF Authorized. That the purchase of Emergency Equipment to retrofit the Administrative Police Vehicle and the use of LETF funds to purchase the Equipment is hereby authorized and approved.

Section 3. Implementation. That the Mayor and Town Manager are authorized to take any and all action necessary to implement this Resolution.

Section 4. Effective Date. That this Resolution shall be effective immediately upon adoption.

Sponsored by the Town Administration.

The Motion to adopt the foregoing Resolution was offered by Vice Mayor Bernstein, seconded by Councilmember Lusskin and on roll call the following vote ensued:

Mayor Glenn Singer	<u>Aye</u>
Vice Mayor Kenneth Bernstein	<u>Aye</u>
Councilmember Amy Isackon-Rojas	<u>Aye</u>
Councilmember Bernard Einstein	<u>Aye</u>
Councilmember Judy Lusskin	<u>Aye</u>

PASSED AND ADOPTED by the Town Council of the Town of Golden Beach, Florida, this 20th day of September, 2016.



MAYOR GLENN SINGER

ATTEST:



LISSETTE PEREZ
TOWN CLERK

APPROVED AS TO FORM
AND LEGAL SUFFICIENCY:

for 

STEPHEN J. HELFMAN
TOWN ATTORNEY



PRIDE Enterprises

Heavy Vehicle Renovation

3950 Tiger Bay Road/ Daytona Beach FL 32124
P.O. Box 10620/ Daytona Beach FL 32120
Main: 888-774-6144 / Fax: 813-890-2115
JBennett@Pride-Enterprises.org

#SO _____

Date: 9/14/2016
Prop#: 10172-2

To: GOLDEN BEACH POLICE DEPARTMENT
1 GOLDEN BEACH DRIVE
GOLDEN BEACH, FL 33160

Contact: CHIEF RUDY HERBELLO
Phone: (305) 936-2444
Cell: (305) 206-6265
Fax: (305) 932-2045
E-mail: RHerbello@goldenbeach.us

Vehicle Make: INTERNATIONAL
Vehicle Model: AMBULANCE/RESCUE BOX
Vehicle Year:

Vehicle Tag No.: 141172
Vehicle VIN No.:
Vehicle Mileage:

CUSTOMER PROPOSAL

CONVERT TO MOBILE CMD VEHICLE

PHASE I

Administration

Work to be done:

- ✓ Complete inspection of the vehicle upon arrival. Notify customer of any irregularities and/or concerns.
- ✓ Quality inspection upon completion.

Body Shop

Work to be done:

- ✓ The vehicle will be pressure washed, degreased, and disassembled as needed to facilitate refinishing.
- ✓ Remove graphics, apply primer filler, and block sand.
- ✓ Remove existing emergency lights, including front and rear lightbars and fill holes where necessary.
- ✓ Make repairs to areas affected by the fabrication process.
- ✓ Sand, seal, and prep entire vehicle for the application of the finish coat.
- ✓ All damaged and rusted areas will be assessed for any additional needed repairs.

The customer will be provided with an estimate for repair.

Paint Shop

Work to be done:

- ✓ The exterior of the vehicle and the door jambs will be painted gloss black and white using a base coat clear coat process.
- ✓ Apply Cool Seal to the roof of the vehicle on the box section.
- ✓ Apply black Scorpion coating to the floor and to a height of approximately six (6) inches along the base of the walls in the box section of the vehicle.

Metal Fabrication

Work to be done:

- ✓ Remove rear doors and seal off the rear section of the box.
- ✓ Modify front driver side exterior access compartment to accommodate a fixed mounted 8 Kw diesel generator.
- ✓ Fabricate and install bracing in the ceiling for the future installation of a roof mounted A/C unit.

Carpentry

Work to be done:

- ✓ Remove existing contents of the box section of the vehicle and prepare the walls, ceiling, and floor for the conversion process (see attached drawings).
- ✓ Driver Side:
 - Design, fabricate, and install an electrical closet constructed of plywood covered with either laminate or carpet (customer selected style and color). All doors shall be positive latching.
 - Design, fabricate, and install a media cabinet constructed of plywood covered with either laminate or carpet (customer selected style and color). All doors shall be positive latching.
 - Design, fabricate, and install a storage cabinet constructed of plywood covered with either laminate or carpet (customer selected style and color). All doors shall be positive latching.
- ✓ Passenger Side
 - Rebuild front passenger side cabinet in a manner similar to existing design. The interior of the cabinet shall be made accessible from both the interior and exterior of the vehicle.
 - Design, fabricate, and install two (2) workstations constructed of laminate covered plywood (customer selected style).
 - Design, fabricate, and install overhead cabinets above workstations constructed of plywood covered with either laminate or carpet (customer selected style and color). Doors shall be sliding tinted Plexiglas.
- ✓ Purchase and apply black or gray carpet to the ceiling and interior walls.

Electrical

Work to be done:

- ✓ Remove electrical hardware from the box section of the vehicle and prepare for the conversion process.
- ✓ Purchase and install a shore power inlet and transfer switch.
- ✓ Purchase and install interior 120 volt outlets as needed.
- ✓ Purchase and install interior 120 volt outlets with built-in HDMI chargers at workstation and in galley area.
- ✓ Purchase and install two (2) HDMI connections at each workstation connected to the media closet.
- ✓ Purchase and install Whelen white round LED lights with chrome flanges in the ceiling as needed.

Total: \$25,000.00

- ✓ Purchase and install six (6) Whelen 900 Series LED lights (customer choice of lens and light color) in the following locations: two (2) on each side of the vehicle and two (2) on the rear of the vehicle.
- ✓ Purchase and install one (1) Whelen 900 Series Scene light on the passenger side of the vehicle at the entry door.
- ✓ Purchase and install two (2) Whelen M4 Series LED (customer choice of lens and light color) in on the grill.

Total: \$2,760.00

- ✓ Replace marker lights with LED lights.

Total: \$225.00

- ✓ Purchase and install Whelen 600 Series brake, turn, and backup lights.

Total: \$1,010.00

PHASE II

Electrical

Work to be done:

- ✓ Purchase and install an 8 Kw diesel generator. Installation to include exhaust pipes for generator, panel, remote start/stop switch, breaker box, wiring harness, and fuel plumbing.
- ✓ Purchase and install insulation in generator compartment.
- ✓ Purchase and install a 120 volt electrical panel.

- ✓ Purchase and install a 12 volt electrical panel.
- ✓ Purchase and install a transfer switch.
- ✓ Purchase and install two (2) 1010 CCA batteries (or approximate equivalent). Installation to include wiring harnesses and electrical boxes.
- ✓ Purchase and install one a converter/charger to provide 12 volt power source from generator output.
- ✓ Purchase and install one (1) non-ducted roof mounted A/C units with built-in thermostats and heat strip.

Upholstery

Work to be done:

- ✓ Fabricate and install various straps to secure various appliances while vehicle is in transit.

Total: \$26,350.00

PHASE III

Electrical

Work to be done:

- ✓ Purchase and install a cassette style electric awning on the roof of the vehicle on the passenger side. Installation to include all brackets, structural support modifications, and wiring harnesses needed.

Total: \$2,150.00

- ✓ Purchase and install a back-up camera with a monitor on the dashboard, and a back-up alarm.

Total: \$565.00

- ✓ Purchase and install a 50-inch monitor on the rear wall using a full swivel mount.
- ✓ Purchase and install two (2) HDMI connections at the 50-inch monitor on the rear wall connected to a panel in the media closet.
- ✓ Purchase and install a roof mounted HD TV antenna with coaxial connections at rear wall TV and in media closet at the panel.
- ✓ Purchase and install a Matrix switch in media closet with 4-inputs and a minimum of 4-outputs.

Total: \$2,345.00

PHASE I FLOOR PLAN

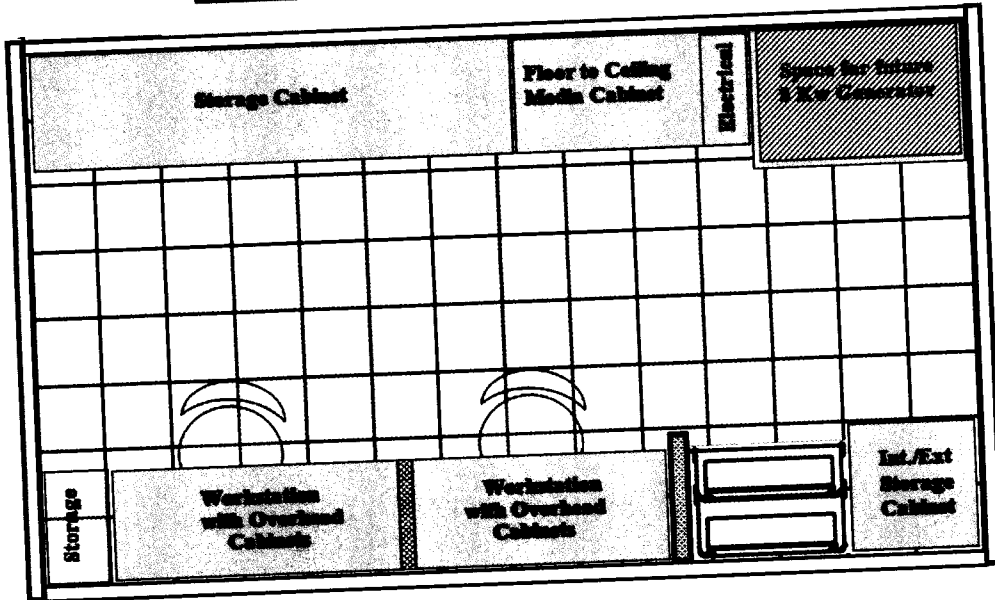

ATTENTION

No windshield, back glass, quarter glass, or reveal molding can be removed without the possibility of breakage. Liability for such damage shall remain with the customer with the additional cost becoming an amendable item.

Any equipment/appliances/hardware removed during conversion work will be discarded unless otherwise agreed to in writing.

READ BEFORE SIGNING

Please read the proposal before signing. If repairs or services are not listed in the proposal they will not be done, unless agreed to in writing by both parties with a contract addendum.

This proposal is valid for sixty (60) days from the date listed above. If work does not commence within sixty (60) days from the proposal date, all prices are subject to change.

PRIDE will inspect all vehicles upon arrival and notify the customer of any additional work required.

All communications equipment, personal property, and paper documents must be removed from the vehicle (or vehicles) prior to their delivery to PRIDE.

Vehicle completion time is dependent upon production scheduling, the availability of parts, institutional matters beyond PRIDE control, and complications arising from the conversion process such as, but not limited to, those involving the electrical and mechanical system. Emergency vehicles take precedence over other current contracted on-site jobs. Our prices are based on reusable or rebuilt cores. Terms are net thirty (30) from completion of each contract entered into FOB PRIDE Tomoka. Any proposals produced from PRIDE on-site inspections are based from previously undetected or unreported hidden damage prior to vehicle delivery. Any and all amendments must be agreed upon and signed by both parties for work commencement to be authorized.

WARRANTY: Paint twelve (12) months. Parts per existing manufacturer's warranty, plus a one (1) year craftsmanship/service warranty on work ordered per said contract.

By signing this proposal, any previously issued proposals utilizing the same proposal number, including revisions, are null and void in their entirety.

Signatures of the following lines authorizes PRIDE Enterprises to perform all scope of work specified on the previous pages of this contract.

Signature of Authorized Agent: _____ DATE: _____

Signature of Tomoka HVR Manager: *Randy Kuykendall* DATE: 9/14/2016

PLEASE BE ADVISED

All work performed on this vehicle will be done within a secured area that does not permit any type of communications equipment or firearms / weapons on the premises.

By signing below, you are certifying that all communications equipment, firearms / weapons, and personal property have been or will be removed prior to delivery of the vehicle to PRIDE. PRIDE will not be responsible for any property left in the vehicle.

SIGNATURE OF THE AUTHORIZED AGENT: _____