

TOWN OF GOLDEN BEACH, FLORIDA

RESOLUTION NO. 2862.23

A RESOLUTION OF THE TOWN COUNCIL OF THE TOWN OF GOLDEN BEACH, FLORIDA, AUTHORIZING AND APPROVING THE FINAL SITE PLAN FOR THE RE-IMAGINED TWEDDLE PARK; AUTHORIZING THE ADMINISTRATION TO PREPARE CONSTRUCTION-READY DOCUMENTS; PROVIDING FOR IMPLEMENTATION; AND PROVIDING FOR AN EFFECTIVE DATE.

WHEREAS, the Town wishes to expand its recreational offerings at the new Civic Center Complex and has developed a new project referred to as the "Re-Imagined" Tweddle Park; and

WHEREAS, the Town Council has held a series of meetings and listening sessions in an effort to incorporate the desires of the community in the new/added recreational offerings in the park; and

WHEREAS, the Town Council hereby accepts and approves the enclosed design as FINAL and authorizes the Administration to prepare construction-ready documents and solicit proposals for the construction of the project as designed.

NOW, THEREFORE, BE IT RESOLVED BY THE TOWN COUNCIL OF THE TOWN OF GOLDEN BEACH, FLORIDA, AS FOLLOWS:

Section 1. Recitals Adopted. Each of the above stated recitals are hereby adopted and confirmed.

Section 2. Purchase Authorized and Approved. The proposed site plan as attached as Exhibit "A" is hereby approved and ratified and accepted.

Section 3. Implementation. The Town Mayor and Town Manager are hereby directed to take the approved site plan, prepare a construction document and solicit proposals for the construction of said project.

Section 4. Effective Date. This Resolution shall be effective immediately upon adoption.

The Motion to adopt the foregoing Resolution was offered by Councilmember Lusskin, seconded by Vice Mayor Bernstein and on roll call the following vote ensued:

Mayor Glenn Singer	<u>Aye</u>
Vice Mayor Kenneth Bernstein	<u>Aye</u>
Councilmember Judy Lusskin	<u>Aye</u>
Councilmember Jaime Mendal	<u>Absent</u>
Councilmember Bernard Einstein	<u>Aye</u>

PASSED AND ADOPTED by the Town Council of the Town of Golden Beach, Florida, this 21st day of March, 2023.



MAYOR GLENN SINGER

ATTEST:



LISSETTE PEREZ
TOWN CLERK

APPROVED AS TO FORM
AND LEGAL SUFFICIENCY:



STEPHEN J. HELFMAN
TOWN ATTORNEY



TOWN OF GOLDEN BEACH

One Golden Beach Drive
Golden Beach, FL 33160

MEMORANDUM

Date: March 21, 2023

To: Honorable Mayor Glenn Singer &
Town Council Members

From: Alexander Diaz, Town Manager *Alex B*

Subject: **Approach and Implementation of the site plan and project phasing for the proposed Re-imagined Tweddle Park and Wellness Center**

Approach and Implementation:

The town has been working over the past eight months to propose a site plan that will encompass all the amenities desired by the residents. The town has held workshops and meetings to ensure that the residents were included in the process that would ultimately produce a final site plan. We have had several members of our community give us valuable insight into what is most important to them. It is important for the process to be guided by how our community lives and plays.

In the planning phase of the Re-Imagined Tweddle Park, we are expanding on what will be our new Civic Center Complex. The phasing of this project will include:

Phase 1 –

Protecting the existing playground and pavilion

- Construction of a barrier wall spanning east to west; from the rear of the Civic Center to Golden Beach Drive.

Recreational Courts Installation

- Earthwork, grading & drainage. A new elevation of the proposed tennis courts (+6.85 NGVD) which will require the installation of retaining walls surrounding the new tennis courts.

- Installation of (2) Hard surface Tennis Courts, (1) Turf Tennis Court & (2) Pickleball courts
- Installation of all perimeter fencing (Including Acoustical panels for sound mitigation), drinking fountains, court and pathway lighting.
- Installation of walkways using a combination of pavers and concrete banding.

Phase 2 –

Retrofit of pump station 1 at Tweddle Park

- Decommission the existing wells. A process in which an abandoned well will be filled and sealed as per required standards.
- Install (2) new downstream defenders and approx. 1,000 linear feet of stormwater pipe connected to the existing outfall.
- Install (2) new mechanical pump motors to pressurize the system, converting from a gravity to forced.
- The general contractor will complete the earthwork and drainage for new playground area. The selected playground designer will deliver a ‘turn-key’ site to include the ground surface material, playground equipment, & shade structures.

Wellness Center Site Preparations

- Demolition of the existing Town Hall building.
- The general contractor will complete the earthwork (filling the site to an elevation of +9.0 NAVD) and drainage for the Wellness Center Building area. The adjacent area to the east will be used for staging during the installation of the playground and construction of the Wellness Center.

Phase 3-

Demolition of the existing playground and Pavilion and Site Preparations

- Demolition of the existing structures
- Installation of the drainage system for the junior basketball court.
- Earthwork to fill the site to new elevation (+6.85 NGVD)
- Installation of new perimeter wall at the northern property line

Jr. Basketball Court Installation

- Installation of new junior basketball court & lighting

Recreational Court Shade Pavilion

- Construction of the recreational shade structure located adjacent to the tennis and basketball court.

Furry Friends Area

- Restoration of the lawn where the tot lot previously resided
- Installation of fencing and landscape shade trees
- Installation of benches, drinking fountains, and lighting

- Installation of play equipment for dogs

Wellness Center

- Completion of the Wellness Center

Youth Play Area (approx. 9,200 sq/ft)

- Earthwork and fill to elevate the site new elevation (+5.85 NGVD)
- Installation of drainage and plumbing lines for new water feature and drinking fountains
- Installation of footings required for play equipment and shade structures
- Installation of sub-surface in preparation for rubberized flooring material
- Installation of play equipment, & shade structures
- Installation of rubberized flooring, benches, & drinking fountains
- Landscape restoration

Fiscal Impact:

The Re-Imagined Tweddle Park will have an initial budget of \$1.2- million to \$1.5-million dollars.

The following areas are not included in the scope of services in the proposed budget:

- Pump Station Scope
- Wellness Center Site Preparations
- Wellness Center

Town of

Golden BEACH

@axxis_ca
www.axxisca.com

Masterplan Tweddle Park

100 Golden Beach Dr, Golden Beach, FL

Presented by:

A · X · X · I · S
DESIGN & CONSTRUCTION

Playground

In Artistic Rendering



Playground

Playing Areas for All Ages

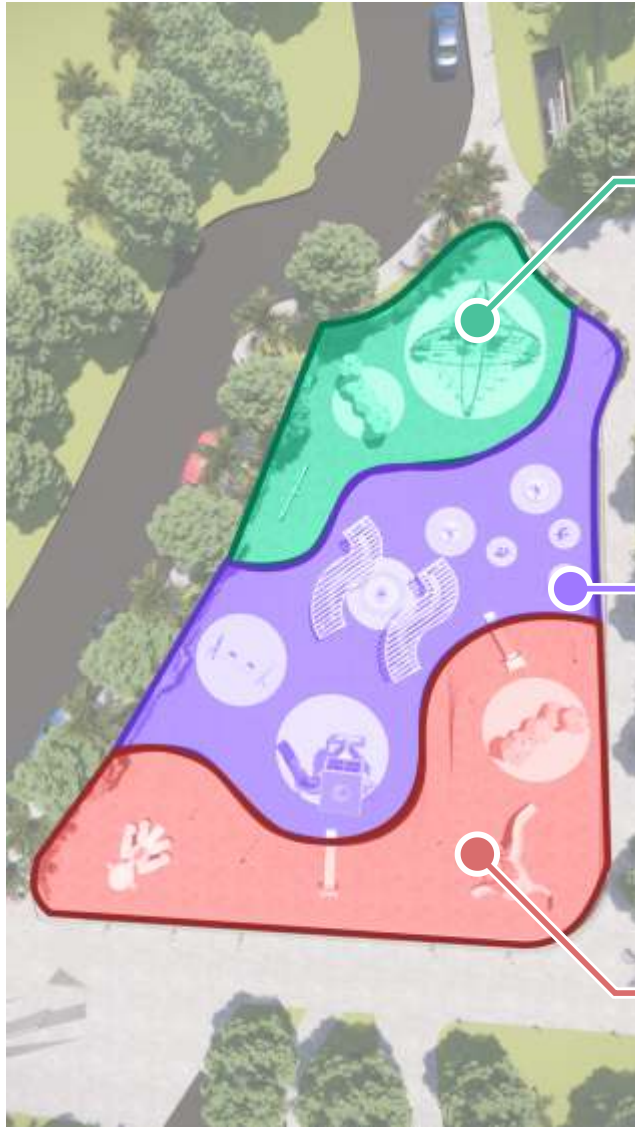

Children aged
10-12 years old



Children aged
3-6 years old



Children aged
7-9 years old



Playground

Equipment & Providers, with Renders and Pictures



Climbable Animals

Kampan - Let's Play
(Made to order)



BLOQX 5

Kompan - Let's Play



Triple Cube

Kompan - Let's Play

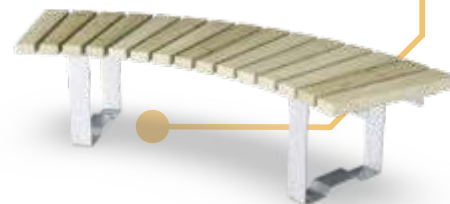

Rumba Bench, Curved, 60°

Kompan - Let's Play



**Hill Climber Rope
With EPDM, Type 4**

Kompan - Let's Play

Playground

Equipment & Providers, with Renders and Pictures



Seesaw, 2 persons
Kompan - Let's Play



Two Seat Swing
Kompan - Let's Play

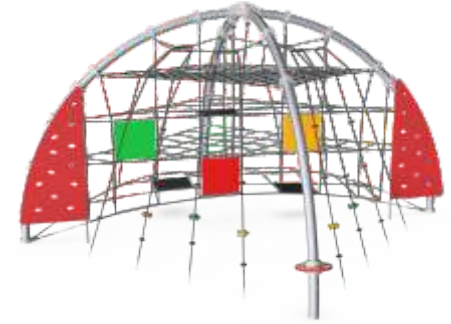

Performer Dome
Kompan - Let's Play



Embankment Slide, wide
Kompan - Let's Play



Bee Spring
Kompan - Let's Play



Carousel with Seats
Kompan - Let's Play

Playground

Seating Area

Equipment & Providers, with Renders and Pictures



- Floor Fountain Jets
- Shaded Area, custom design
- Sculpture, custom design

Additional Shading Structures



Floral elements for shading

Landscape Structures PlayLSI



Sail-type roof

Landscape Structures PlayLSI



Green Leaf Shade Structures

Versatile Structures

Sports Courts

In Artistic Rendering



Sports Courts

Seating Area

Equipment & Providers, with Renders and Pictures



Custom Architectural
Green Roofing Design



FAZ Coffee Table
(White)
Vandom



FAZ Lounge Chair
(White)
Vandom, provided by
Lumens



FAZ Bench
(White)
Vandom



UFO Coffee
Table (Red)
Vandom, provided by
Lumens



UFO Outdoor
Lounge Chair
(White)
Vandom, provided by
Lumens

Equipment

Sports Field Lighting

Equipment placement in Sports Courts Plan



- Pickleball Lighting
- Basketball Lighting
- Tennis Lighting

Recommended height for
Recreational Court Lighting Poles:

20'-26' range

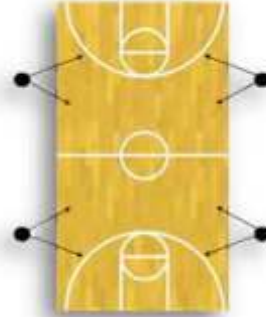

Basketball Guideline
for Light Placement

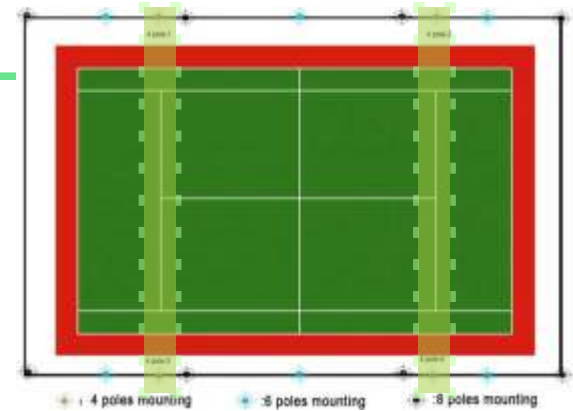

Tennis Guideline for Light Placement,
4-poles mounting

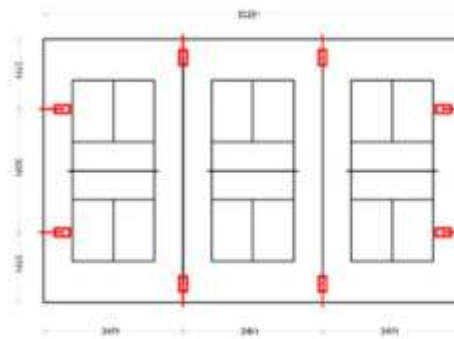

Pickleball Guideline for Light Placement

Three Court - 8 Fixture Lighting System 102 X 64ft
Install 8 pieces 400 watts LED pickleball court lights



Equipment

Equipment & Providers, with Renders and Pictures



Steel Litter Bin for Waste Sorting
Archiproducts



Teak Bench with back
Archiproducts



Lamps for walkways
landscapeforms, France



LED Court Lights and lampposts
for Pickleball, Basketball & Tennis courts
LedLightExpert.com



Bike Coil Bicycle Racks
Belson Outdoors, USA

Equipment

Equipment placement in Master Plan



Lamps for walkways
landscapeforms, France



Steel Litter Bin for
Waste Sorting
Archiproducts



Bench Placement
Archiproducts

Equipment

Equipment placement & Providers, with Renders and Pictures



Outdoor Drinking Fountain

Color: White

PRO Drinking Fountains



• **Bottle Filling Station**



• **Bi-Level**



• **Pet Fountain**

Flooring and Sidewalks

Equipment with Renders and Pictures

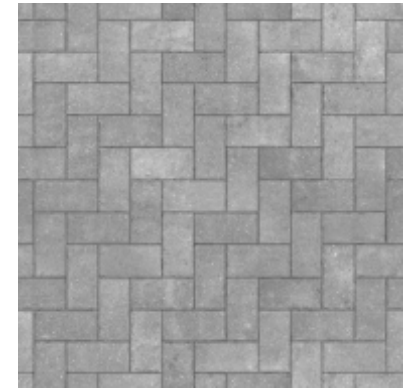

Walkaway Pattern



Rubber Chipping Floor

Dog Park

Equipment & Providers, with Renders and Pictures



Varied equipment for
interactivity and agility play
Barkpark & others

Sculpture Area

In Artistic Rendering

