

TOWN OF GOLDEN BEACH, FLORIDA

RESOLUTION NO. 2818.22

A RESOLUTION OF THE TOWN OF GOLDEN BEACH, FLORIDA, AUTHORIZING AND APPROVING A CONTRACT WITH SOUTHEASTERN ENGINEERING CONTRACTORS, INC. TO INSTALL ADDITIONAL LANDSCAPING AT THE CENTER ISLAND PUMP STATION; PROVIDING FOR WAIVER OF COMPETITIVE BIDDING; PROVIDING FOR IMPLEMENTATION; AND PROVIDING FOR AN EFFECTIVE DATE.

WHEREAS, the Town Council wishes to engage Southeastern Engineering Contractors, Inc. ("Southeastern") to perform certain landscape improvements to complete and enhance the Veteran's Memorial right-of-way near the Center Island Pump Station (the "Work"), for an amount not to exceed \$27,335.24; and

WHEREAS, Southeastern has agreed to perform the Work; and

WHEREAS, the Town and Southeastern wish to enter into a contract for the Work, pursuant to the terms of the proposal attached hereto as Exhibit "A" to this Resolution (the "Proposal"); and

WHEREAS, the Work is exempt from competitive bidding under Florida law, and it is otherwise impractical to competitively bid the Work; and

WHEREAS, the Town Council has determined that it is in the best interests of the Town to make the roadway improvements and to approve a contract with Southeastern;

NOW, THEREFORE, BE IT RESOLVED BY THE TOWN COUNCIL OF THE TOWN OF GOLDEN BEACH, FLORIDA, AS FOLLOWS:

Section 1. Recitals Adopted. Each of the above stated recitals are hereby adopted, confirmed and incorporated herein.

Section 2. Authorization and Approval. The Town Council hereby authorizes and approves a contract with Southeastern pursuant to the terms of the Proposal attached hereto as Exhibit "A," authorizes the Mayor to execute the contract on behalf of the Town once approved as to form and legal sufficiency by the Town Attorney, and authorizes the expenditure of funds as detailed in the attached Proposal.

Section 3. Waiver of Competitive Bidding. Pursuant to the Town's Ordinance No. 540.09, the Town Council hereby finds that it is impractical to competitively bid the Work and not in the best interests of the Town.

Section 4. Implementation. The Town Mayor and Town Manager are hereby authorized to take any and all action necessary to implement this Resolution in accordance with its terms and conditions.

Section 5. Effective Date. This Resolution shall be effective immediately upon adoption.

Sponsored by **Town Administration.**

The Motion to adopt the foregoing Resolution was offered by Councilmember Lusskin, seconded by Councilmember Bernstein, and on roll call the following vote ensued:

Mayor Glenn Singer	<u>Aye</u>
Vice Mayor Jaime Mendal	<u>Aye</u>
Councilmember Bernard Einstein	<u>Aye</u>
Councilmember Judy Lusskin	<u>Aye</u>
Councilmember Kenneth Bernstein	<u>Aye</u>

PASSED AND ADOPTED by the Town Council of the Town of Golden Beach,
Florida, this 17th day of May, 2022.



MAYOR GLENN SINGER

ATTEST:



LISSETTE PEREZ
TOWN CLERK

APPROVED AS TO FORM
AND LEGAL SUFFICIENCY:

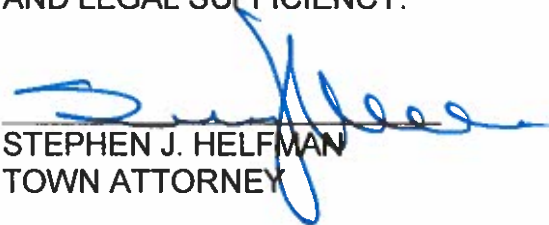

STEPHEN J. HELFMAN
TOWN ATTORNEY



TOWN OF GOLDEN BEACH

One Golden Beach Drive
Golden Beach, FL 33160

MEMORANDUM

Date: May 17, 2022

To: Honorable Mayor Glenn Singer &
Town Council Members

From: Alexander Diaz, *Alex B.*
Town Manager

Subject: Resolution No. 2818.22 – Approving contract with
Southeastern Engineering Contractors to install additional
landscape at Center Island Pump Station

Item Number:

8

Recommendation:

It is recommended that the Town Council adopt the attached Resolution No. 2818.22 as presented.

Background:

The Center Island Pump station closeout is nearly complete. During construction, 393 Center Island Drive (the property to the south) was approved for demolition of the existing residence. Although we had already started site restoration at the pump station, we paused this scope of work in order to prevent any damage to the planned landscape work. Previously, this residence had a driveway access going through the right of way. The new residence will no longer have a driveway at that location thus, the town will reclaim the entire right of way. We have created a plan extending the landscape to complete and enhance the Veteran's Memorial right of way.

Fiscal Impact:

The fiscal impact for this project is \$27,335.24. Funds will come from the 330-519-634-000-20-004 Capital Projects Veteran's Memorial.



PROPOSAL

TOWN OF GOLDEN BEACH

Rev 2

DATE: 5/11/2022

PROJECT DESCRIPTION: Golden Beach CI Landscape Beautification Requested by the City

FINANCIAL PROJECT ID: N/A

PROJECT NO.: N/A

Item	Description	Unit	Qty	U. Price	Total
	<u>General Items</u>				
1	Mobilization	LS	1.00	1,100.00	1,100.00
2	Landscaping Work	LS	1.00	24,515.24	24,515.24
3	Final Restoration and Cleaning	LS	1.00	1,720.00	1,720.00
				TOTAL	\$27,335.24

Payment Terms:

The price(s) quoted here are based on the quantities/measurements stated above. Any change in measurement or quantity may result in a price adjustment. Customer agrees to pay interest on past due payments at the highest rates allowed by law from when payment is due until payment is received by Southeastern. Customer agrees to pay all costs of collections due to non payment and reasonable attorney fees of the contractor in any effort to collect moneys under this agreement. All prices quoted are good for 30 days.

Exclusions:

Permit fees unless specifically accounted for above, HOA fees, landscape restoration or any other work not specifically listed or described in this proposal. If you do not see an item of work described above please do not assume that it is accounted for.

If needed, Town to provide for police services at no cost to SEC.

All work to be performed during daylight hours. Add 1.5 x labor costs for night work.

No restoration or repairs work such as landscaping, irrigation, etc., etc. is included in above items.

Submitted by: **Southeastern Engineering Contractors, Inc.**

911 NW 209th Avenue, Suite 101

Pembroke Pines, Fl. 33029

Accepted by: _____

Town of Golden Beach



**PROPOSAL
Summary of Costs**

11-May-22

Work Order No.		Project Name:								Sheet 1 of 1
DESCRIPTION: <i>Golden Beach CI Landscape Beautification Requested by the City REV2</i>		Contract Number:								
		Item No.	Description of Labor & Equipment	Unit	Quantity	Unit Price	Scheduled Value	Labor Burden		
						%	Total Amount	%	Total Amount	
LABOR										
	SUPERINTENDENT	HR	8	\$45.00	\$360.00	69.49%	\$610.16	10.0%	\$ 61.02	\$671.18
	FOREMAN	HR	8	\$35.00	\$280.00	69.49%	\$474.57	10.0%	\$ 47.46	\$ 522.03
	OPERATOR	HR	8	\$24.00	\$192.00	69.49%	\$325.42	10.0%	\$ 32.54	\$ 357.96
	LABORER	HR	8	\$20.00	\$160.00	69.49%	\$271.18	10.0%	\$ 27.12	\$ 298.30
									\$ -	\$ -
	Totals Labor				\$992.00		\$1,681.34		\$ 168.13	\$1,849.47
EQUIPMENT										
						Not Applicable				
	1/2 TON WORK TRUCK	HR	8	\$16.41	\$131.28	N/A		10.0%	\$ 13.13	\$ 144.41
	BOBCAT	HR	8	\$38.00	\$304.00	N/A		10.0%	\$ 30.40	\$ 334.40
	SMALL TOOLS	HR	8	\$22.00	\$176.00	N/A		10.0%	\$ 17.60	\$ 193.60
	Totals Equipment				\$611.28		\$0.00	0.0	\$61.13	\$ 672.41
MATERIALS										
		LS	1		\$0.00	N/A		10.0%	\$ -	\$ -
	Totals Material				\$0.00		\$0.00	0.0	\$0.00	\$ -
SUBCONTRACTORS										
	VisualScape	LS	1	\$ 19,916.00	\$19,916.00	N/A		10.0%	\$ 1,991.60	\$ 21,907.60
	Totals Subcontractors									\$ 21,907.60
	Fuel Surcharge									\$ 33.62
	General Items									\$ 25.22
	Profit 10%									\$ 2,442.95
	Subtotal:									\$ 26,931.27
	Bid Bond Adjustment									\$ 403.97
	Grand Total Labor, Equipment, & Materials									\$ 27,335.24

Contractor's Certification:

According to the best of my knowledge and belief, I certify that all items and amounts shown on this proposal are correct, that all work will be performed and material supplied in full accordance with the terms and conditions of the Contract. I further certify that all just and lawful bills against the undersigned and his subcontractors for labor, materials, and equipment employed in the performance of the Work will be paid in full in accordance with the Contract's terms and conditions.

Submitted by:

Southeastern Engineering Contractors
911 NW 209th Ave, Suite 101
Pembroke Pines Fl. 33029
305-557-4226

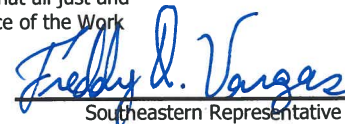
 Southeastern Representative



Landscape Beautification Proposal

Job Name:	Town of Golden Beach Center Island Pump Stat	Date:	4/28/2022
Job Address:	Town of Golden Beach		
Company:	Southeastern Engineering Contractors	Created By:	Adrian Rivero
Contact:	Jose Carlos Perello (305) 557-4226		Rebeca Borrero
Email:	ic@southeasterneq.com		
Billing Address:	911 NW 209th Ave. Suite 101 Pembroke Pines FL 33029	Plans Date:	Rev.1 4/7/2022

Item	Quantity	Unit Price	Total
Trees & Palms			
Cocos nucifera 'Green Malayan' - Green Malayan Coconut Palm CONU 8' gw Certified heavy trunk	1	\$ 975.00	\$ 975.00
Cocos nucifera 'Green Malayan' - Green Malayan Coconut Palm CONU 10' gw Certified heavy trunk	21	\$ 1,100.00	\$ 2,310.00
Cocos nucifera 'Green Malayan' - Green Malayan Coconut Palm CONU 12' gw Certified heavy trunk	2	\$ 1,250.00	\$ 2,500.00
Cocos nucifera 'Green Malayan' - Green Malayan Coconut Palm CONU-C 8-10' gw, Curved Character 48" curve	31	\$ 1,200.00	\$ 3,720.00
Thrinax radiata - Florida Thacht Palm THRA 6' ht, Single FG	20	\$ 400.00	\$ 8,000.00
Shrubs & Groundcovers			
Chrysobalanus icaco 'Horizontal' - Horizontal Cocoplum CHHO 18" ht, 16" sprd, 3 gal, 24" oc	35	\$ 18.00	\$ 630.00
Miscellaneous			
Stenotaphrum secundatum 'Floratum' - St Augustine SF	2,650	\$ 1.05	\$ 2,782.50
Stenotaphrum secundatum 'Seville' - St Augustine SF	1,000	\$ 1.50	\$ 1,500.00
Top Soil and fine grading CY	36	\$ 50.00	\$ 1,800.00
Mulch - Florimulch 3" depth CY	8	\$ 50.00	\$ 377.31
3" depth Brown River Rock CY	48	\$ 550.00	\$ 2,750.00
Filter Fabric SF	600	\$ 1.00	\$ 600.00
Aluminum Edging LF	120	\$ 6.00	\$ 720.00
Remove Existing Schefflera and Coconut Palm EA	1	\$ 1,220.00	\$ 1,220.00
Touch up damaged decorative rock, edging, mulch in the first phase	1	\$ 1,200.00	\$ 1,200.00
Irrigation Systems			
Irrigation Systems LS	1	\$ 2,900.00	\$ 2,900.00
Additional Irrigation for additional landscape as per walkthrough LS	1	\$ 1,000.00	\$ 1,000.00
Landscape			\$ 25,494.81
Irrigation			\$ 3,900.00
Total			\$ 29,394.81

5,775
975
1100
2500
1200
0
630
630
9,811.5
1,711.5
0
1800
400
2200
600
480
1220
1200
3900
16,016
3900
19,916

Notes and Exclusions

- Notes:**
- * Proposal based on plans by O'leary Richards Desing date Rev1. 4/7/2022 pages L1.01 to IR2.02
 - * All areas to be provided to VisualScape clean, clear at finished grade per contract documents, plus or minus one (1) inch (No Excavation of continuous plant be
 - * Quantities in BOLD identify take-off discrepancy from plans and legend
- Exclusions:**
- * Existing tree removal
 - * Existing tree protection
 - * Water meter, water tap
 - * Electrical Connection to controller
 - * Directional bore
 - * Cutting and patching
 - * Permit cost and permit running
 - * Hung/riser pipe, core drilling
 - * Planter drainage and water proofing
 - * Crane if required to be provided at cost plus 20%
 - * MOT
 - * Sod Restoration, Mulch & River Rock - to be provided upon request
 - * Backflow and backflow certification to be provided and installed by others.
 - * Excavation of planting beds including equipment & dumping
 - * Planting Soil - plant beds provided by others. VisualScape can provide a quote upon request.
 - * Boulder Relocations & Pressure Cleaning, if required provided at additional cost

Pricing is valid for 90 days
 17801 NW 137 Avenue ~ Miami, FL 33018
 Tel: (305) 362-2404 ~ Fax: (305) 362-2403
www.VisualScapeInc.com

Upon acceptance of this proposal, client understands and agrees to VisualScape Inc. terms and conditions.

Rev 1 - After bid & After installed

Additional sprinkler zone as per meeting on Apr 20th 2022

installed 1 1/2" as per original plan.

Updated proposed irrigation line has increased the pipe size and length

NOTE: THESE EXISTING SPRINKLERS SHALL REMAIN. CONNECT EXISTING PIPING TO NEW LATERAL AT MOST CONVENIENT LOCATION.

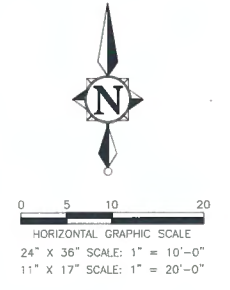
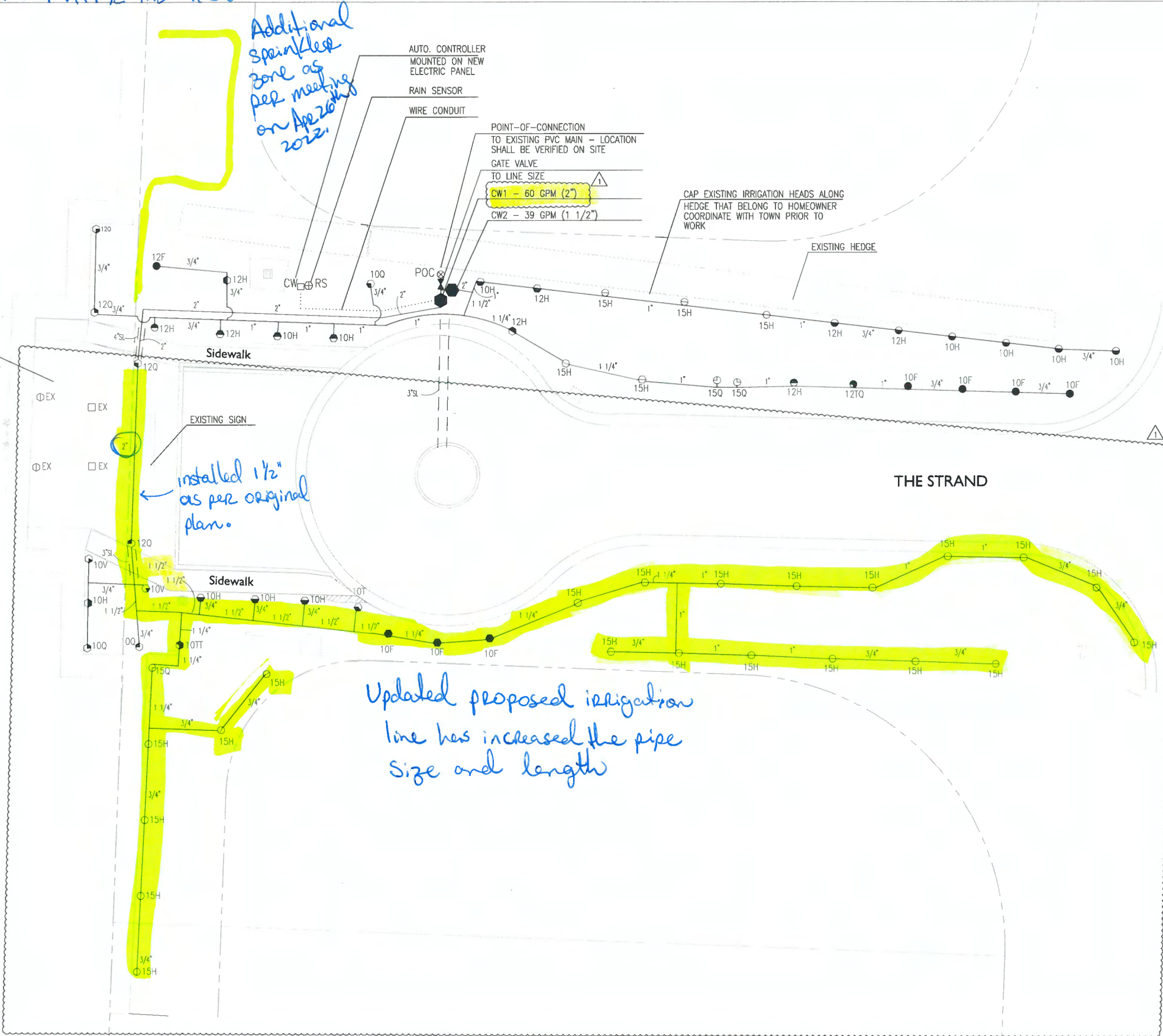

FOR CONSTRUCTION

NO.	DATE	REVISION	BY

Date: 07/17/2020
 Designed: _____
 Drawn: _____
 Checked: _____

APPROVED BY: KATHRYN O'LEARY RICHARDS
 DATE _____
 FLORIDA LANDSCAPE ARCHITECT NO. LA0001317

O'Leary Richards Design Associates, Inc.
 O'LEARY RICHARDS DESIGN
 LANDSCAPE ARCHITECTURE & PLANNING
 8525 SW 92nd STREET, STE. C-118
 MIAMI, FLORIDA 33196
 (305) 596-6628
 LA CERTIFICATE NO. LC26000195

PREPARED FOR:
 TOWN OF GOLDEN BEACH
 MIAMI DADE COUNTY, FLORIDA

CENTER ISLAND PUMP STATION
 IRRIGATION PLAN

FILE NAME: IR1.01_Rev #1.dwg
 LAST SAVED: 04/12/22 - 3:32pm
 CAS PROJECT NUMBER
 18-2025

SHEET
 IR1.01

Original

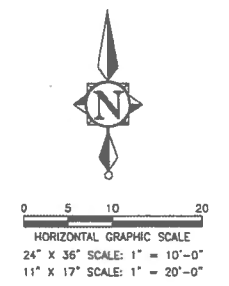

NOTE:
THESE EXISTING SPRINKLERS SHALL REMAIN. CONNECT EXISTING PIPING TO NEW LATERAL AT MOST CONVENIENT LOCATION.

NOTE
EXISTING SPRINKLERS IN THE CIRCLE SHALL BE CAPPED

40% of original irrigation scope of work not installed

INTRACOASTAL WATERWAY

CENTER ISLAND

THE STRAND

EXISTING DRIVEWAY

EXISTING HEDGE

Sidewalk

Sidewalk

- AUTO. CONTROLLER MOUNTED ON NEW ELECTRIC PANEL
- RAIN SENSOR
- WIRE CONDUIT
- POINT-OF-CONNECTION TO EXISTING PVC MAIN - LOCATION SHALL BE VERIFIED ON SITE
- GATE VALVE TO LINE SIZE
- CW1 - 25+ GPM (1 1/2")
- CW2 - 39 GPM (1 1/2")

CAP EXISTING IRRIGATION HEADS ALONG HEDGE THAT BELONG TO HOMEOWNER COORDINATE WITH TOWN PRIOR TO WORK

EXISTING HEDGE

BID SET

FOR CONSTRUCTION

NO.	DATE	REVISION	BY

Date: 07/17/2020
Designed: _____
Drawn: _____
Checked: _____

APPROVED BY: KATHRYN O'LEARY RICHARDS
DATE _____
FLORIDA LANDSCAPE ARCHITECT NO. LA0001317

O'Leary Richards Design Associates, Inc.
O'LEARY RICHARDS DESIGN
LANDSCAPE ARCHITECTURE & PLANNING
8525 SW 92nd STREET, STE. C-111B
MIAMI, FLORIDA 33156
(305) 596-6628
LA CERTIFICATE NO. LC26000195

PREPARED FOR:
TOWN OF GOLDEN BEACH
MIAMI DADE COUNTY, FLORIDA

CENTER ISLAND PUMP STATION
IRRIGATION PLAN

FILE NAME: IR1.01.dwg
LAST SAVED: 07/18/20 - 3:26pm
CAS PROJECT NUMBER
18-2025

SHEET
IR1.01

Rev 1

LEGEND

SYMBOL	MODEL NO.	DESCRIPTION	* EST. QUANTITY
● 10H	1804-10H	RAIN BIRD 4" POP-UP SPRAY	04
● 10F	1804-10F	RAIN BIRD 4" POP-UP SPRAY	04
● 12H	1804-12H	RAIN BIRD 4" POP-UP SPRAY	04
● 12F	1804-12F	RAIN BIRD 4" POP-UP SPRAY	01
⊖ 15Q	1804-15Q	RAIN BIRD 4" POP-UP SPRAY	03
⊖ 15H	1804-15H	RAIN BIRD 4" POP-UP SPRAY	22
⊖ 10V	1812-10V	RAIN BIRD 12" POP-UP SPRAY	02
⊖ 10Q	1812-10Q	RAIN BIRD 12" POP-UP SPRAY	03
⊖ 10H	1812-10H	RAIN BIRD 12" POP-UP SPRAY	07
⊖ 10TT	1812-10TT	RAIN BIRD 12" POP-UP SPRAY	01
⊖ 10F	1812-10F	RAIN BIRD 12" POP-UP SPRAY	03
⊖ 10T	1812-10T	RAIN BIRD 12" POP-UP SPRAY	01
⊖ 12Q	1812-12Q	RAIN BIRD 12" POP-UP SPRAY	04
⊖ 12H	1812-12H	RAIN BIRD 12" POP-UP SPRAY	02
⊖ 15H	1812-15H	RAIN BIRD 12" POP-UP SPRAY	04
●	200 PEB	RAIN BIRD 2" SOLENOID VALVE	01
●	150 PEB	RAIN BIRD 1 1/2" SOLENOID VALVE	01
□ CW	ESP-4ME	RAIN BIRD AUTOMATIC CONTROLLER	01
⊕ RS	RSD-BEX	RAIN BIRD RAIN SENSOR	01
NOT SHOWN	#14AWG	PAIGE THHN WIRE	AS REQUIRED
---		SCH 40 PVC	AS REQUIRED
---		MAIN LINE	
---		LATERALS	
---		SLEEVES	
NOT SHOWN		PVC FITTINGS	
NOT SHOWN		SPRINKLER RISERS	
•••••		WIRE CONDUIT	
⊗		GATE VALVE (TO LINE SIZE)	01
⊗		VALVE BOX	03
□ CW		GROUNDING LOCATION	01
⊗ POC		POINT-OF-CONNECTION	01
⊖ EX, □ EX, ⊖ EX		SPRINKLERS	EXISTING

NOTE: ABOVE QUANTITIES ARE FOR COMPARISON ONLY. CONTRACTOR SHALL VERIFY PRIOR TO SUBMITTING BID.

ZONE SUMMARY CHART

STA NO.	VALVE TYPE	SPRINKLER	VALVE SIZE	WATER DEMAND	RUN *TIME	WEEKLY USAGE
1	CW1	SPRAY	2"	60 GPM	40 MIN/WK	2,400 GAL/WK
2	CW2	SPRAY	1 1/2"	39 GPM	40 MIN/WK	1,560 GAL/WK
3-4	SPARE					
					80 MIN/WK	3,960 GAL/WK

*TO APPLY 1.0 IN/WK.

IRRIGATION NOTES & SPECIFICATIONS

AUTOMATIC IRRIGATION SYSTEM

WATER DEMAND / ZONE REFER TO PLAN
 WATER SOURCE CITY WATER
 PRESSURE REQUIRED 50 PSI

GENERAL

IRRIGATION SHALL BE INSTALLED IN ACCORDANCE WITH LOCAL CODES, CONTRACT DRAWINGS, CONTRACT SPECIFICATIONS, AND APPENDIX "F" OF THE FLORIDA BUILDING CODE.

IRRIGATION DESIGN BASED ON "LANDSCAPE PLAN" DATED JULY 17, 2020. CONTRACTOR SHALL REFER TO THIS PLAN TO COORDINATE SPRINKLER LOCATIONS AND PIPE ROUTING WITH NEW AND EXISTING PLANT LOCATIONS.

THIS IRRIGATION PLAN SHALL BE USED AS A GUIDE. CONTRACTOR SHALL INSTALL IRRIGATION TO MATCH ON SITE CONDITIONS AND TO OVERCOME THE INHERENT INACCURACIES THAT RESULT WHEN DESIGNING FROM BASE PLANS SCALED AT 1" = 10'.

THIS IRRIGATION HAS BEEN DESIGNED AS A TYPICAL BLOCK VALVE TYPE USING RAIN BIRD SPRINKLERS, IN-LINE VALVES, AND CONTROL SYSTEM. A RAIN SENSOR SHALL BE INSTALLED TO CONSERVE WATER.

THE SOURCE SHALL BE AN EXISTING WATER METER. THE LOCATION OF THE POINT-OF-CONNECTION TO AN EXISTING MAIN LINE SHALL BE VERIFIED ON SITE.

CONTRACTOR IS ADVISED TO STUDY THE PLANS FOR ADDITIONAL INFORMATION AND VISIT THE SITE TO BECOME FAMILIAR WITH EXISTING CONDITIONS.

TO ENSURE PROPER OPERATION, PRESSURE REQUIRED, VALVE SIZES, ZONE CAPACITIES, SPRINKLER SPACING, PIPE AND WIRE SIZES, AND INSTALLATION NOTES AND DETAILS, AND SPECIFICATIONS SHALL BE FOLLOWED AS SHOWN.

EXISTING IRRIGATION HEADS THAT ARE REMOVED ARE TO BE STOCKPILED FOR TOWN USE. COORDINATE WITH TOWN'S LANDSCAPE MAINTENANCE CONTRACTOR.

PIPING

PIPE ROUTING IS SCHEMATIC ONLY AND SHALL BE ADJUSTED FOR ON SITE CONDITIONS. PIPE SHALL BE INSTALLED TO MINIMIZE DAMAGE TO THE ROOT SYSTEMS OF EXISTING LANDSCAPING.

PIPE SHALL BE INSTALLED IN ACCORDANCE WITH LOCAL CODES AND PIPE MANUFACTURER'S INSTRUCTIONS.

PIPE ROUTED UNDER HARDSCAPED AREAS SHALL BE SLEEVED IN SCH 40 PVC. EACH SLEEVE SHALL BE: (1) BURIED TO A MINIMUM DEPTH OF 18", (2) TWO PIPE SIZES LARGER THAN CARRIER PIPE, AND (3) EXTENDED 3' BEYOND HARDSCAPED AREA. CONTRACTOR SHALL VERIFY THE SIZE, DEPTH AND LOCATION OF ALL EXISTING SLEEVES.

ALL PIPE AND FITTINGS SHALL BE SCH 40 TYPE 1120 PVC.

PIPE SIZED TO LIMIT FLOW VELOCITIES TO 5 FEET/SECOND AND TO LIMIT FRICTION LOSS IN THE PIPING NETWORK.

PIPE SHALL BE INSTALLED AT SUFFICIENT DEPTH BELOW GROUND TO PROTECT IT FROM HAZARD SUCH AS VEHICULAR TRAFFIC OR ROUTINE OCCURRENCES WHICH OCCUR IN THE NORMAL USE AND MAINTENANCE OF THE PROPERTY. DEPTHS OF COVER SHALL MEET OR EXCEED SCS CODE 430-DD. REFER TO THE APPLICABLE DETAIL FOR ADDITIONAL INFORMATION.

BACKFILL SHALL BE OF SUITABLE MATERIAL, FREE OF ROCKS, STONES, AND OTHER DEBRIS THAT WOULD DAMAGE IRRIGATION SYSTEM COMPONENTS.

A GATE VALVE SHALL BE INSTALLED FOR ISOLATION. THIS VALVE SHALL BE TO LINE SIZE AND INSTALLED IN A VALVE BOX. POROUS MATERIAL SHALL BE INSTALLED PER BOX TO PROMOTE DRAINAGE.

SPRINKLERS

SPRINKLER LOCATIONS ARE SCHEMATIC ONLY AND SHALL BE ADJUSTED FOR LANDSCAPING, FENCES, SITE LIGHTING, PREVAILING WIND, MOUNDING, ETC., TO ENSURE PROPER COVERAGE WITH MINIMAL UNDESIRABLE OVERTHROW. A PRIME OBJECTIVE SHALL BE TO ELIMINATE OVERTHROW ONTO PAVEMENT, AND SIDEWALKS.

SPRAY HEADS SHALL BE RAIN BIRD 1800 SERIES. FOUR INCH POP-UP TYPE SHALL BE INSTALLED IN AREAS LANDSCAPED WITH SOD AND MULCH, AND TWELVE INCH POP-UP TYPE SHALL BE INSTALLED IN AREAS LANDSCAPED WITH GROUND COVER AND SHRUBS.

POP-UP TYPE LOCATED IN SOD, MULCH, AND GROUND COVERS SHALL BE INSTALLED ON FLEXIBLE SWING JOINTS CONSISTING OF THICKWALLED POLY PIPE AND 1/2" INSERT ELBOWS.

POP-UP TYPE LOCATED IN SHRUBS SHALL BE INSTALLED ON 1/2" SCH 40 PVC RISERS TO A HEIGHT SO SPRINKLERS ARE CONCEALED FROM VIEW EXCEPT DURING USE.

EACH SPRINKLER SHALL BE EQUIPPED WITH THE APPROPRIATE SPRAY NOZZLE.

ADJUSTMENT FEATURES OF SPRINKLERS SPECIFIED SHALL BE UTILIZED TO ENSURE PROPER COVERAGE WITH MINIMAL UNDESIRABLE OVERTHROW. LOW ANGLE, FLAT SPRAY, AND ADJUSTABLE ARC NOZZLES SHALL BE USED TO MINIMIZE OVERTHROW.

SPRINKLERS LOCATED ADJACENT TO HARDSCAPED AREAS SHALL BE INSTALLED AWAY FROM HARDSCAPED AREAS TO MINIMIZE OVERTHROW AND THE CHANCE OF DAMAGE BY VEHICLES, PEDESTRIANS, AND LAWN MAINTENANCE PERSONNEL. AS A GENERAL RULE, 4" POP-UP SPRAY HEADS SHALL BE INSTALLED IN 4", AND 12" POP-UP SPRAY HEADS SHALL BE INSTALLED IN 12".

CONTROL SYSTEM

CONTROL SYSTEM SHALL BE A RAIN BIRD ESP SERIES ELECTRIC TYPE. ONE 4 STATION CONTROLLER SHALL ACTIVATE 2 IN-LINE VALVES. A RAIN SENSOR SHALL BE INSTALLED TO CONSERVE WATER.

CONTROLLER SHALL BE INSTALLED IN ACCORDANCE WITH LOCAL CODES AND MANUFACTURER'S INSTRUCTIONS. PROPER GROUNDING EQUIPMENT SHALL BE PROVIDED.

CONTROLLER LOCATION SHALL BE APPROVED BY THE OWNER'S REPRESENTATIVE. A 110 VAC ELECTRIC SOURCE IS REQUIRED.

CONTROL LINES FROM AUTOMATIC CONTROLLER TO IN-LINE AUTOMATIC VALVES SHALL BE #14 AWG THHN TYPE WHICH SHALL BE: (1) INSTALLED IN ACCORDANCE WITH LOCAL CODES, (2) INSTALLED IN SCH 40 PVC WIRE CONDUIT, (3) BURIED TO A MINIMUM DEPTH OF 15", (4) COLORED CODED TO FACILITATE TROUBLESHOOTING, AND (5) SPLICED MOSTLY AT VALVE LOCATIONS. SPLICES SHALL BE MADE WATERPROOF USING APPROVED METHODS. SPARE WIRES SHALL BE ROUTED FROM THE CONTROLLER IN ALL DIRECTIONS TO THE FARTHEST VALVES CONTROLLED.

AN INDIVIDUAL CONTROL WIRE SHALL BE ROUTED TO EACH VALVE AND VALVES WHICH OPERATE SIMULTANEOUSLY SHALL BE TEED TOGETHER AT THE CONTROLLER.

AUTOMATIC VALVE LOCATIONS ARE SCHEMATIC ONLY AND SHALL BE ADJUSTED FOR ON SITE CONDITIONS. EACH VALVE SHALL BE INSTALLED IN A VALVE BOX. A MINIMUM OF ONE CUBIC FOOT OF GRAVEL SHALL BE PROVIDED PER BOX TO PROMOTE DRAINAGE.

THE RAIN SENSOR SHALL BE INSTALLED IN ACCORDANCE WITH MANUFACTURER'S INSTRUCTIONS.

TIMING AND PRECIPITATION

TIMING OF EACH STATION SHALL BE SET IN THE FIELD TO MATCH LOCAL REQUIREMENTS. REFER TO ZONE SUMMARY CHART FOR RECOMMENDED RUN TIMES TO APPLY 1.0 INCHES/WEEK.

FOR CONSTRUCTION

NO.	DATE	REVISION	BY

Date: 07/17/2020
 Designed: _____
 Drawn: _____
 Checked: _____

APPROVED BY: KATHRYN O'LEARY RICHARDS
 DATE: _____
 FLORIDA LANDSCAPE ARCHITECT NO. LA0001317

O'Leary Richards Associates, Inc.
O'LEARY RICHARDS DESIGN
 LANDSCAPE ARCHITECTURE & PLANNING
 8525 SW 92nd STREET, STE. C-11B
 MIAMI, FLORIDA 33156
 (305) 596-8628
 LA CERTIFICATE NO. LC26000195

PREPARED FOR:
TOWN OF GOLDEN BEACH
MIAMI DADE COUNTY, FLORIDA

CENTER ISLAND PUMP STATION
IRRIGATION LEGEND & NOTES

FILE NAME: IR2.01 & IR2.02_Rev #1.dwg
 LAST SAVED: 04/12/22 - 4:30pm
 CAS PROJECT NUMBER
18-2025

SHEET
IR2.01

Original

LEGEND

SYMBOL	MODEL NO.	DESCRIPTION	* EST. QUANTITY
● 8F	1804-8F	RAIN BIRD 4" POP-UP SPRAY	01
● 10V	1804-10V	RAIN BIRD 4" POP-UP SPRAY	01
● 10Q	1804-10Q	RAIN BIRD 4" POP-UP SPRAY	02
● 10H	1804-10H	RAIN BIRD 4" POP-UP SPRAY	10
● 10TQ	1804-10TQ	RAIN BIRD 4" POP-UP SPRAY	01
● 10F	1804-10F	RAIN BIRD 4" POP-UP SPRAY	04
● 12H	1804-12H	RAIN BIRD 4" POP-UP SPRAY	04
● 12F	1804-12F	RAIN BIRD 4" POP-UP SPRAY	01
● SST	1804-15SST	RAIN BIRD 4" POP-UP SPRAY	03
● 15Q	1804-15Q	RAIN BIRD 4" POP-UP SPRAY	02
● 15H	1804-15H	RAIN BIRD 4" POP-UP SPRAY	03
● 10V	1812-10V	RAIN BIRD 12" POP-UP SPRAY	03
● 10Q	1812-10Q	RAIN BIRD 12" POP-UP SPRAY	02
● 10H	1812-10H	RAIN BIRD 12" POP-UP SPRAY	09
● 10TT	1812-10TT	RAIN BIRD 12" POP-UP SPRAY	01
● 10F	1812-10F	RAIN BIRD 12" POP-UP SPRAY	02
● 12V	1812-12V	RAIN BIRD 12" POP-UP SPRAY	01
● 12Q	1812-12Q	RAIN BIRD 12" POP-UP SPRAY	03
● 12H	1812-12H	RAIN BIRD 12" POP-UP SPRAY	06
● 15H	1812-15H	RAIN BIRD 12" POP-UP SPRAY	02
● 150 PEB	150 PEB	RAIN BIRD 1 1/2" SOLENOID VALVE	02
□ CW	ESP-4ME	RAIN BIRD AUTOMATIC CONTROLLER	01
⊕ RS	RSD-BEX	RAIN BIRD RAIN SENSOR	01
NOT SHOWN	#14AWG	PAIGE THHN WIRE	AS REQUIRED
---		<u>SCH 40 PVC</u>	AS REQUIRED
---		MAIN LINE	
---		LATERALS	
---		SLEEVES	
NOT SHOWN		PVC FITTINGS	
NOT SHOWN		SPRINKLER RISERS	
.....		WIRE CONDUIT	
⊗		GATE VALVE (TO LINE SIZE)	01
●		VALVE BOX	03
□ CW		GROUNDING LOCATION	01
⊗ POC		POINT-OF-CONNECTION	01
⊕ EX, □ EX, ⊕ EX		SPRINKLERS	EXISTING

NOTE: ABOVE QUANTITIES ARE FOR COMPARISON ONLY. CONTRACTOR SHALL VERIFY PRIOR TO SUBMITTING BID.

ZONE SUMMARY CHART

STA NO.	VALVE TYPE	SPRINKLER	VALVE SIZE	WATER DEMAND	RUN *TIME	WEEKLY USAGE
1	CW1	SPRAY	1 1/2"	35 GPM	40 MIN/WK	1,400 GAL/WK
2	CW2	SPRAY	1 1/2"	39 GPM	40 MIN/WK	1,560 GAL/WK
3-4	SPARE					
					80 MIN/WK	2,960 GAL/WK

*TO APPLY 1.0 IN/WK.

IRRIGATION NOTES & SPECIFICATIONS

AUTOMATIC IRRIGATION SYSTEM

WATER DEMAND / ZONE REFER TO PLAN
 WATER SOURCE CITY WATER
 PRESSURE REQUIRED 50 PSI

GENERAL

IRRIGATION SHALL BE INSTALLED IN ACCORDANCE WITH LOCAL CODES, CONTRACT DRAWINGS, CONTRACT SPECIFICATIONS, AND APPENDIX "F" OF THE FLORIDA BUILDING CODE.

IRRIGATION DESIGN BASED ON "LANDSCAPE PLAN" DATED JULY 17, 2020. CONTRACTOR SHALL REFER TO THIS PLAN TO COORDINATE SPRINKLER LOCATIONS AND PIPE ROUTING WITH NEW AND EXISTING PLANT LOCATIONS.

THIS IRRIGATION PLAN SHALL BE USED AS A GUIDE. CONTRACTOR SHALL INSTALL IRRIGATION TO MATCH ON SITE CONDITIONS AND TO OVERCOME THE INHERENT INACCURACIES THAT RESULT WHEN DESIGNING FROM BASE PLANS SCALED AT 1" = 10'.

THIS IRRIGATION HAS BEEN DESIGNED AS A TYPICAL BLOCK VALVE TYPE USING RAIN BIRD SPRINKLERS, IN-LINE VALVES, AND CONTROL SYSTEM. A RAIN SENSOR SHALL BE INSTALLED TO CONSERVE WATER.

THE SOURCE SHALL BE AN EXISTING WATER METER. THE LOCATION OF THE POINT-OF-CONNECTION TO AN EXISTING MAIN LINE SHALL BE VERIFIED ON SITE.

CONTRACTOR IS ADVISED TO STUDY THE PLANS FOR ADDITIONAL INFORMATION AND VISIT THE SITE TO BECOME FAMILIAR WITH EXISTING CONDITIONS.

TO ENSURE PROPER OPERATION, PRESSURE REQUIRED, VALVE SIZES, ZONE CAPACITIES, SPRINKLER SPACING, PIPE AND WIRE SIZES, AND INSTALLATION NOTES AND DETAILS, AND SPECIFICATIONS SHALL BE FOLLOWED AS SHOWN.

EXISTING IRRIGATION HEADS THAT ARE REMOVED ARE TO BE STOCKPILED FOR TOWN USE. COORDINATE WITH TOWN'S LANDSCAPE MAINTENANCE CONTRACTOR.

PIPING

PIPE ROUTING IS SCHEMATIC ONLY AND SHALL BE ADJUSTED FOR ON SITE CONDITIONS. PIPE SHALL BE INSTALLED TO MINIMIZE DAMAGE TO THE ROOT SYSTEMS OF EXISTING LANDSCAPING.

PIPE SHALL BE INSTALLED IN ACCORDANCE WITH LOCAL CODES AND PIPE MANUFACTURER'S INSTRUCTIONS.

PIPE ROUTED UNDER HARDSCAPED AREAS SHALL BE SLEEVED IN SCH 40 PVC. EACH SLEEVE SHALL BE: (1) BURIED TO A MINIMUM DEPTH OF 18", (2) TWO PIPE SIZES LARGER THAN CARRIER PIPE, AND (3) EXTENDED 3' BEYOND HARDSCAPED AREA. CONTRACTOR SHALL VERIFY THE SIZE, DEPTH AND LOCATION OF ALL EXISTING SLEEVES.

ALL PIPE AND FITTINGS SHALL BE SCH 40 TYPE 1120 PVC.

PIPE SIZED TO LIMIT FLOW VELOCITIES TO 5 FEET/SECOND AND TO LIMIT FRICTION LOSS IN THE PIPING NETWORK.

PIPE SHALL BE INSTALLED AT SUFFICIENT DEPTH BELOW GROUND TO PROTECT IT FROM HAZARD SUCH AS VEHICULAR TRAFFIC OR ROUTINE OCCURRENCES WHICH OCCUR IN THE NORMAL USE AND MAINTENANCE OF THE PROPERTY. DEPTHS OF COVER SHALL MEET OR EXCEED SCS CODE 430-DD. REFER TO THE APPLICABLE DETAIL FOR ADDITIONAL INFORMATION.

BACKFILL SHALL BE OF SUITABLE MATERIAL, FREE OF ROCKS, STONES, AND OTHER DEBRIS THAT WOULD DAMAGE IRRIGATION SYSTEM COMPONENTS.

A GATE VALVE SHALL BE INSTALLED FOR ISOLATION. THIS VALVE SHALL BE TO LINE SIZE AND INSTALLED IN A VALVE BOX. POROUS MATERIAL SHALL BE INSTALLED PER BOX TO PROMOTE DRAINAGE.

SPRINKLERS

SPRINKLER LOCATIONS ARE SCHEMATIC ONLY AND SHALL BE ADJUSTED FOR LANDSCAPING, FENCES, SITE LIGHTING, PREVAILING WIND, MOUNDING, ETC., TO ENSURE PROPER COVERAGE WITH MINIMAL UNDESIRABLE OVERTHROW. A PRIME OBJECTIVE SHALL BE TO ELIMINATE OVERTHROW ONTO PAVEMENT, AND SIDEWALKS.

SPRAY HEADS SHALL BE RAIN BIRD 1800 SERIES. FOUR INCH POP-UP TYPE SHALL BE INSTALLED IN AREAS LANDSCAPED WITH SOD AND MULCH, AND TWELVE INCH POP-UP TYPE SHALL BE INSTALLED IN AREAS LANDSCAPED WITH GROUND COVER AND SHRUBS.

POP-UP TYPE LOCATED IN SOD, MULCH, AND GROUND COVERS SHALL BE INSTALLED ON FLEXIBLE SWING JOINTS CONSISTING OF THICKWALLED POLY PIPE AND 1/2" INSERT ELBOWS.

POP-UP TYPE LOCATED IN SHRUBS SHALL BE INSTALLED ON 1/2" SCH 40 PVC RISERS TO A HEIGHT SO SPRINKLERS ARE CONCEALED FROM VIEW EXCEPT DURING USE.

EACH SPRINKLER SHALL BE EQUIPPED WITH THE APPROPRIATE SPRAY NOZZLE.

ADJUSTMENT FEATURES OF SPRINKLERS SPECIFIED SHALL BE UTILIZED TO ENSURE PROPER COVERAGE WITH MINIMAL UNDESIRABLE OVERTHROW. LOW ANGLE, FLAT SPRAY, AND ADJUSTABLE ARC NOZZLES SHALL BE USED TO MINIMIZE OVERTHROW.

SPRINKLERS LOCATED ADJACENT TO HARDSCAPED AREAS SHALL BE INSTALLED AWAY FROM HARDSCAPED AREAS TO MINIMIZE OVERTHROW AND THE CHANCE OF DAMAGE BY VEHICLES, PEDESTRIANS, AND LAWN MAINTENANCE PERSONNEL. AS A GENERAL RULE, 4" POP-UP SPRAY HEADS SHALL BE INSTALLED IN 4", AND 12" POP-UP SPRAY HEADS SHALL BE INSTALLED IN 12".

CONTROL SYSTEM

CONTROL SYSTEM SHALL BE A RAIN BIRD ESP SERIES ELECTRIC TYPE. ONE 4 STATION CONTROLLER SHALL ACTIVATE 2 IN-LINE VALVES. A RAIN SENSOR SHALL BE INSTALLED TO CONSERVE WATER.

CONTROLLER SHALL BE INSTALLED IN ACCORDANCE WITH LOCAL CODES AND MANUFACTURER'S INSTRUCTIONS. PROPER GROUNDING EQUIPMENT SHALL BE PROVIDED.

CONTROLLER LOCATION SHALL BE APPROVED BY THE OWNER'S REPRESENTATIVE. A 110 VAC ELECTRIC SOURCE IS REQUIRED.

CONTROL LINES FROM AUTOMATIC CONTROLLER TO IN-LINE AUTOMATIC VALVES SHALL BE #14 AWG THHN TYPE WHICH SHALL BE: (1) INSTALLED IN ACCORDANCE WITH LOCAL CODES, (2) INSTALLED IN SCH 40 PVC WIRE CONDUIT, (3) BURIED TO A MINIMUM DEPTH OF 15", (4) COLORED CODED TO FACILITATE TROUBLESHOOTING, AND (5) SPLICED MOSTLY AT VALVE LOCATIONS. SPLICES SHALL BE MADE WATERPROOF USING APPROVED METHODS. SPARE WIRES SHALL BE ROUTED FROM THE CONTROLLER IN ALL DIRECTIONS TO THE FARTHEST VALVES CONTROLLED.

AN INDIVIDUAL CONTROL WIRE SHALL BE ROUTED TO EACH VALVE AND VALVES WHICH OPERATE SIMULTANEOUSLY SHALL BE TIED TOGETHER AT THE CONTROLLER.

AUTOMATIC VALVE LOCATIONS ARE SCHEMATIC ONLY AND SHALL BE ADJUSTED FOR ON SITE CONDITIONS. EACH VALVE SHALL BE INSTALLED IN A VALVE BOX. A MINIMUM OF ONE CUBIC FOOT OF GRAVEL SHALL BE PROVIDED PER BOX TO PROMOTE DRAINAGE.

THE RAIN SENSOR SHALL BE INSTALLED IN ACCORDANCE WITH MANUFACTURER'S INSTRUCTIONS.

TIMING AND PRECIPITATION

TIMING OF EACH STATION SHALL BE SET IN THE FIELD TO MATCH LOCAL REQUIREMENTS. REFER TO ZONE SUMMARY CHART FOR RECOMMENDED RUN TIMES TO APPLY 1.0 INCHES/WEEK.

BID SET

FOR CONSTRUCTION

NO.	DATE	REVISION	BY

Date: 07/17/2020
 Designed: _____
 Drawn: _____
 Checked: _____

APPROVED BY: KATHRYN O'LEARY RICHARDS
 DATE: _____
 FLORIDA LANDSCAPE ARCHITECT NO. LA0001317

O'Leary Richards Design Associates, Inc.
 O'LEARY RICHARDS DESIGN
 LANDSCAPE ARCHITECTURE & PLANNING
 8525 SW 92nd STREET, STE C-118
 MIAMI, FLORIDA 33150
 (305) 598-6628
 LA CERTIFICATE NO. LC26000195

PREPARED FOR:
TOWN OF GOLDEN BEACH
MIAMI DADE COUNTY, FLORIDA

CENTER ISLAND PUMP STATION
IRRIGATION LEGEND & NOTES

FILE NAME: IR2.01 & IR2.02.dwg
 LAST SAVED: 07/20/20 - 1:25pm
 CAS PROJECT NUMBER
18-2025

SHEET
IR2.01

Rev 1

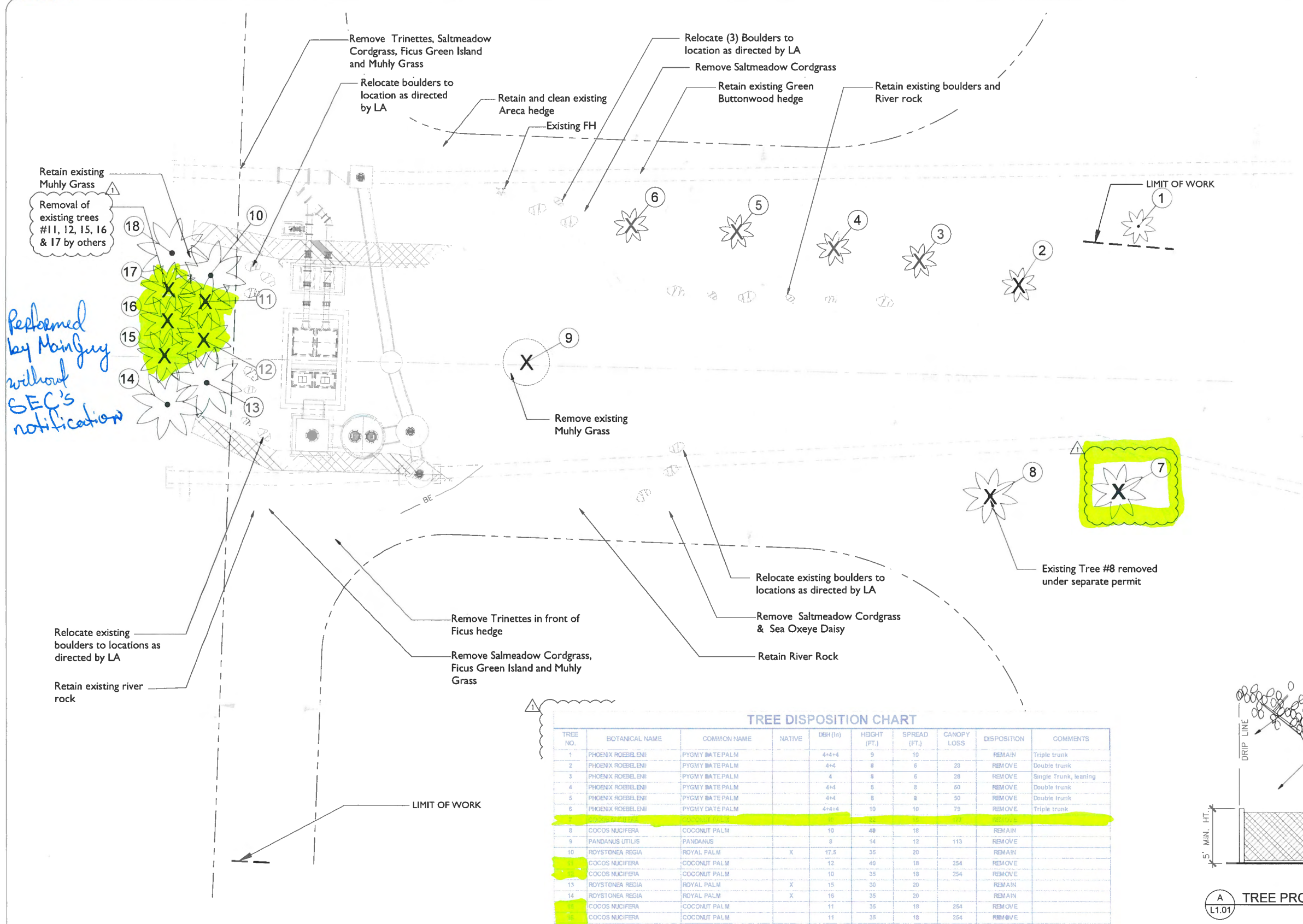
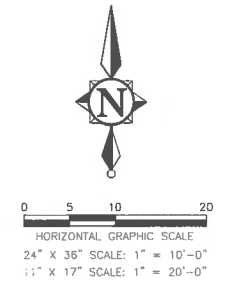

Reformed by Manjiv without SEC's notification

- LEGEND**
- EXISTING TREE TO BE REMOVED
 - EXISTING PALM TO BE REMOVED
 - #1** TREE INVENTORY NUMBER
 - EXISTING PALM TO REMAIN

TREE DISPOSITION CHART

TREE NO.	BOTANICAL NAME	COMMON NAME	NATIVE	DBH (IN)	HEIGHT (FT.)	SPREAD (FT.)	CANOPY LOSS	DISPOSITION	COMMENTS
1	PHOENIX ROEBELENI	PYGMY DATE PALM		4+4	9	10		REMAIN	Triple trunk
2	PHOENIX ROEBELENI	PYGMY DATE PALM		4+4	8	6	23	REMOVE	Double trunk
3	PHOENIX ROEBELENI	PYGMY DATE PALM		4	8	6	28	REMOVE	Single Trunk, leaning
4	PHOENIX ROEBELENI	PYGMY DATE PALM		4+4	8	8	50	REMOVE	Double trunk
5	PHOENIX ROEBELENI	PYGMY DATE PALM		4+4	8	8	50	REMOVE	Double trunk
6	PHOENIX ROEBELENI	PYGMY DATE PALM		4+4	10	10	79	REMOVE	Triple trunk
7	PHOENIX ROEBELENI	PYGMY DATE PALM		4+4	10	10	79	REMOVE	Triple trunk
8	COCOS NUCIFERA	COCONUT PALM		10	48	18		REMAIN	
9	PANDANUS UTILIS	PANDANUS		8	14	12	113	REMOVE	
10	ROYSTONIA REGIA	ROYAL PALM	X	17.5	35	20		REMAIN	
11	COCOS NUCIFERA	COCONUT PALM		12	40	18	254	REMOVE	
12	COCOS NUCIFERA	COCONUT PALM		10	35	18	254	REMOVE	
13	ROYSTONIA REGIA	ROYAL PALM	X	15	30	20		REMAIN	
14	ROYSTONIA REGIA	ROYAL PALM	X	19	35	20		REMAIN	
15	COCOS NUCIFERA	COCONUT PALM		11	35	18	254	REMOVE	
16	COCOS NUCIFERA	COCONUT PALM		11	35	18	254	REMOVE	
17	COCOS NUCIFERA	COCONUT PALM		9	35	18	254	REMOVE	
18	ROYSTONIA REGIA	ROYAL PALM	X	18.5	35	20		REMAIN	
TOTAL CANOPY LOSS							1,798		

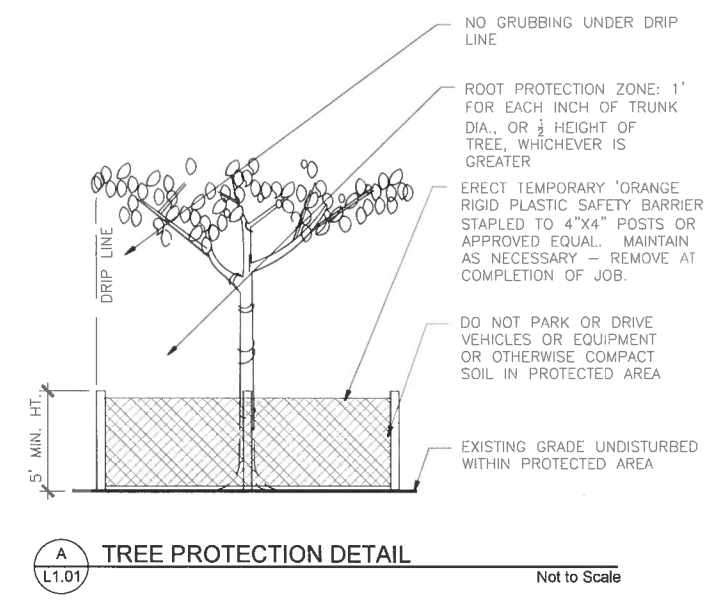

04/07/2022			
NO.	DATE	REVISION	BY

Date: 07/17/2020
 Approved by: KATHRYN O'LEARY RICHARDS
 Designer: _____
 Drawn: _____
 Checked: _____
 DATE: _____
 FLORIDA LANDSCAPE ARCHITECT NO. LA0001317

O'Leary Richards Design Associates, Inc.
 O'LEARY RICHARDS DESIGN
 LANDSCAPE ARCHITECTURE & PLANNING
 8525 SW 92nd STREET, STE. C-118
 MIAMI, FLORIDA 33156
 (305) 595-6628
 LA CERTIFICATE NO. LC26000195

PREPARED FOR:
TOWN OF GOLDEN BEACH
MIAMI DADE COUNTY, FLORIDA

CENTER ISLAND PUMP STATION
TREE DISPOSITION PLAN

FILE NAME: L1.01-Rev #1.dwg
 LAST SAVED: 04/12/22 - 11:02am
 CAS PROJECT NUMBER
18-2025

SHEET
L1.01

FOR CONSTRUCTION

Original

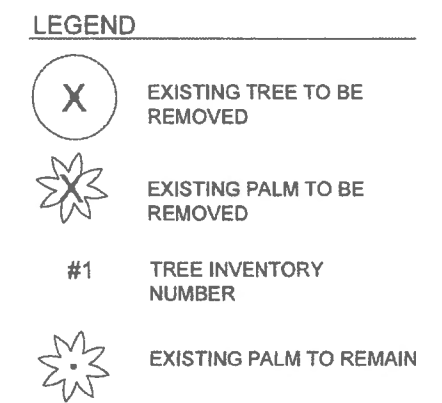
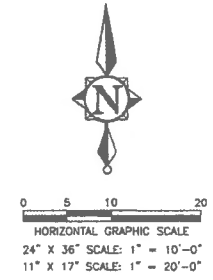
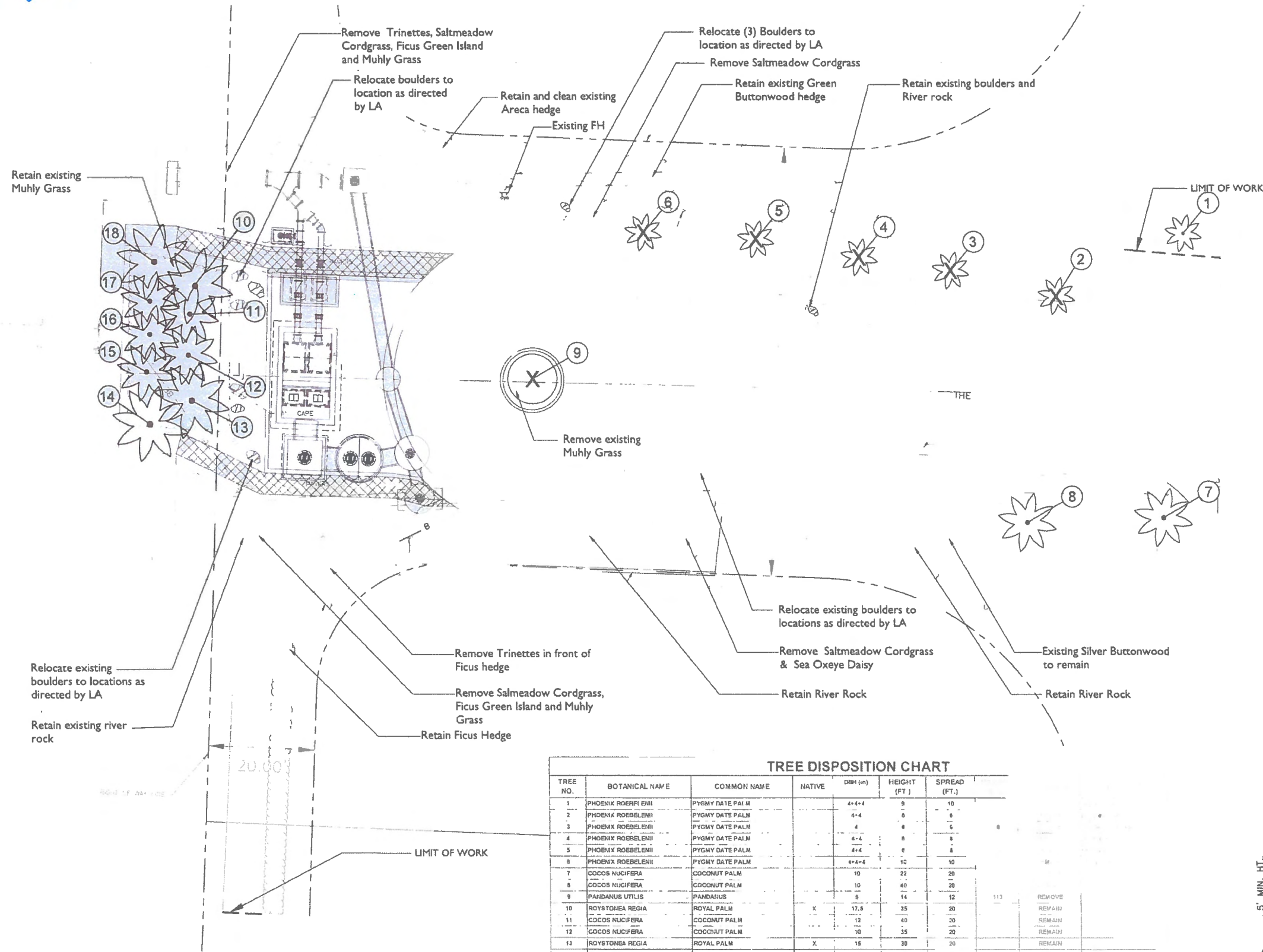

TREE DISPOSITION CHART

TREE NO.	BOTANICAL NAME	COMMON NAME	NATIVE	DBH (in)	HEIGHT (FT.)	SPREAD (FT.)			
1	PHOENIX ROEBELENI	PYGMY DATE PALM		4+4	9	10			
2	PHOENIX ROEBELENI	PYGMY DATE PALM		4+4	9	9			
3	PHOENIX ROEBELENI	PYGMY DATE PALM		4	8	8			
4	PHOENIX ROEBELENI	PYGMY DATE PALM		4+4	8	8			
5	PHOENIX ROEBELENI	PYGMY DATE PALM		4+4	8	8			
6	PHOENIX ROEBELENI	PYGMY DATE PALM		4+4	10	10			
7	COCOS NUCIFERA	COCONUT PALM		10	22	20			
8	COCOS NUCIFERA	COCONUT PALM		10	40	20			
9	PANDANUS UTILIS	PANDANUS		9	14	12	113	REMOVE	
10	ROYSTONIA REGIA	ROYAL PALM	X	17.5	35	20		REMAIN	
11	COCOS NUCIFERA	COCONUT PALM		12	40	30		REMAIN	
12	COCOS NUCIFERA	COCONUT PALM		10	35	20		REMAIN	
13	ROYSTONIA REGIA	ROYAL PALM	X	15	30	20		REMAIN	
14	ROYSTONIA REGIA	ROYAL PALM	X	18	35	20		REMAIN	
15	COCOS NUCIFERA	COCONUT PALM		11	35	20		REMAIN	
16	COCOS NUCIFERA	COCONUT PALM		11	35	30		REMAIN	
17	COCOS NUCIFERA	COCONUT PALM		9	35	30		REMAIN	
18	ROYSTONIA REGIA	ROYAL PALM	X	18.5	35	20		REMAIN	
TOTAL CANOPY LOSS								349	

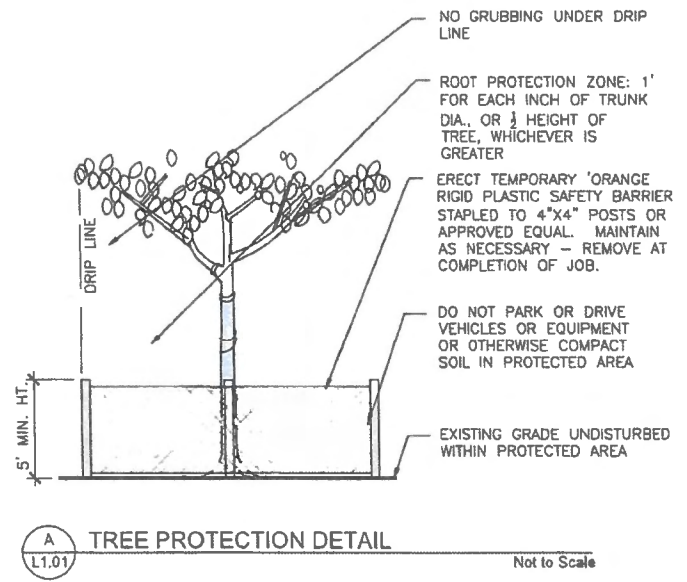

BID SET

FOR CONSTRUCTION

NO.	DATE	REVISION	BY

Date: 07/17/2020
Designed: _____
Drawn: _____
Checked: _____

APPROVED BY: KATHRYN O'LEARY RICHARDS
DATE: _____
FLORIDA LANDSCAPE ARCHITECT NO. LA0001317

O'Leary Richards Associates, Inc.
O'LEARY RICHARDS DESIGN
LANDSCAPE ARCHITECTURE & PLANNING
8525 SW 92nd STREET, STE. C-118
MIAMI, FLORIDA 33156
(305) 596-8628
LA CERTIFICATE NO. LC26000195

PREPARED FOR:
TOWN OF GOLDEN BEACH
MIAMI DADE COUNTY, FLORIDA

CENTER ISLAND PUMP STATION
TREE DISPOSITION PLAN

FILE NAME: L1.01.dwg
LAST SAVED: 07/17/20 - 6:20pm
CAS PROJECT NUMBER
18-2025

SHEET
L1.01

Rev 1

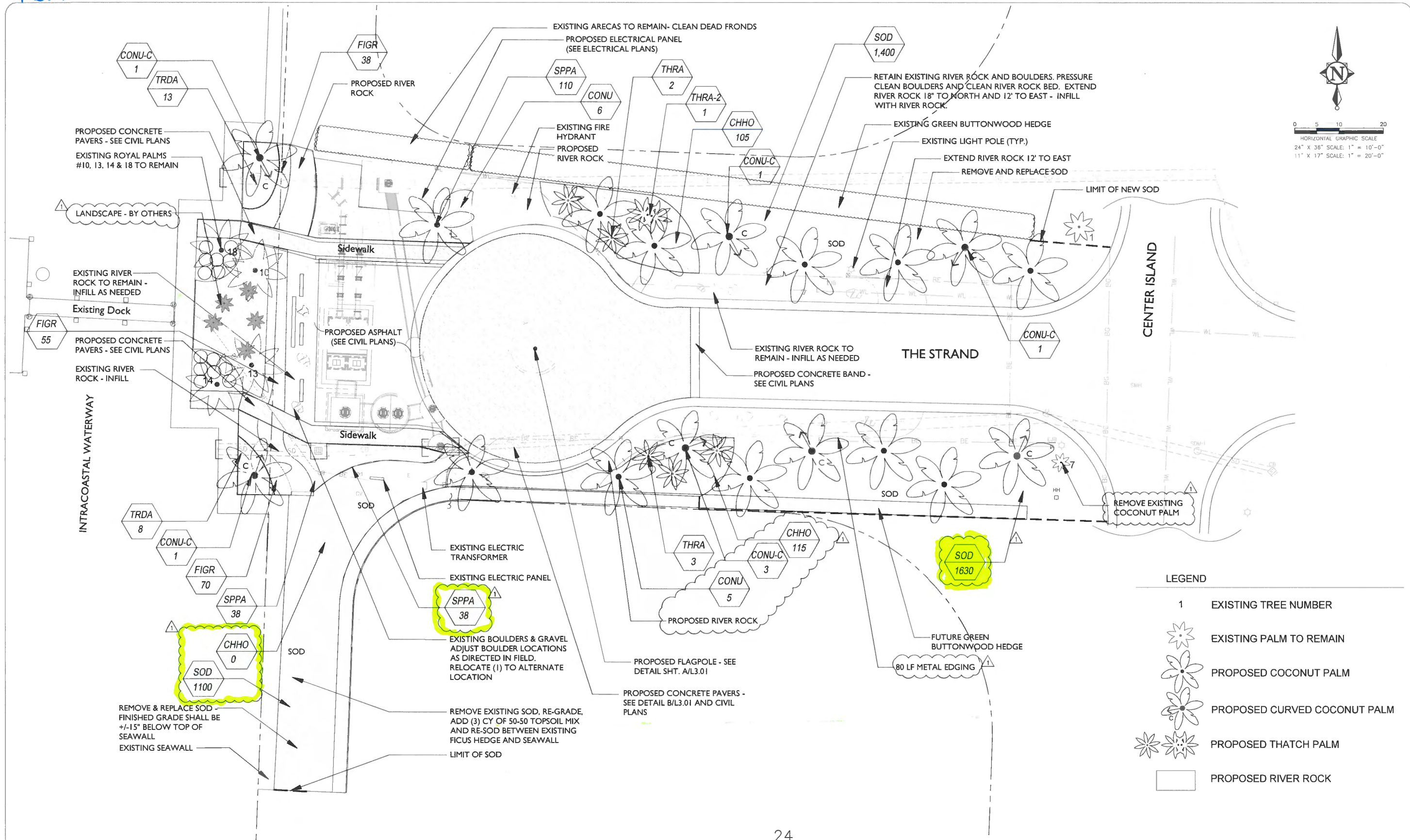

FOR CONSTRUCTION

04/07/2022			
NO.	DATE	REVISION	BY

Date: 07/17/2020
 Designed: _____
 Drawn: _____
 Checked: _____

APPROVED BY: KATHRYN O'LEARY RICHARDS
 DATE _____
 FLORIDA LANDSCAPE ARCHITECT NO. LA0001317

O'Leary Richards Design Associates, Inc.
 O'LEARY RICHARDS DESIGN
 LANDSCAPE ARCHITECTURE & PLANNING
 8525 SW 92nd STREET, STE. C-118
 MIAMI, FLORIDA 33156
 (305) 596-6628
 LA CERTIFICATE NO. LC26000195

PREPARED FOR:
TOWN OF GOLDEN BEACH
MIAMI DADE COUNTY, FLORIDA

CENTER ISLAND PUMP STATION
LANDSCAPE PLAN

FILE NAME: L1.02-Rev #1.dwg
 LAST SAVED: 04/12/22 - 11:13am
 CAS PROJECT NUMBER
18-2025

SHEET
L1.02

Original

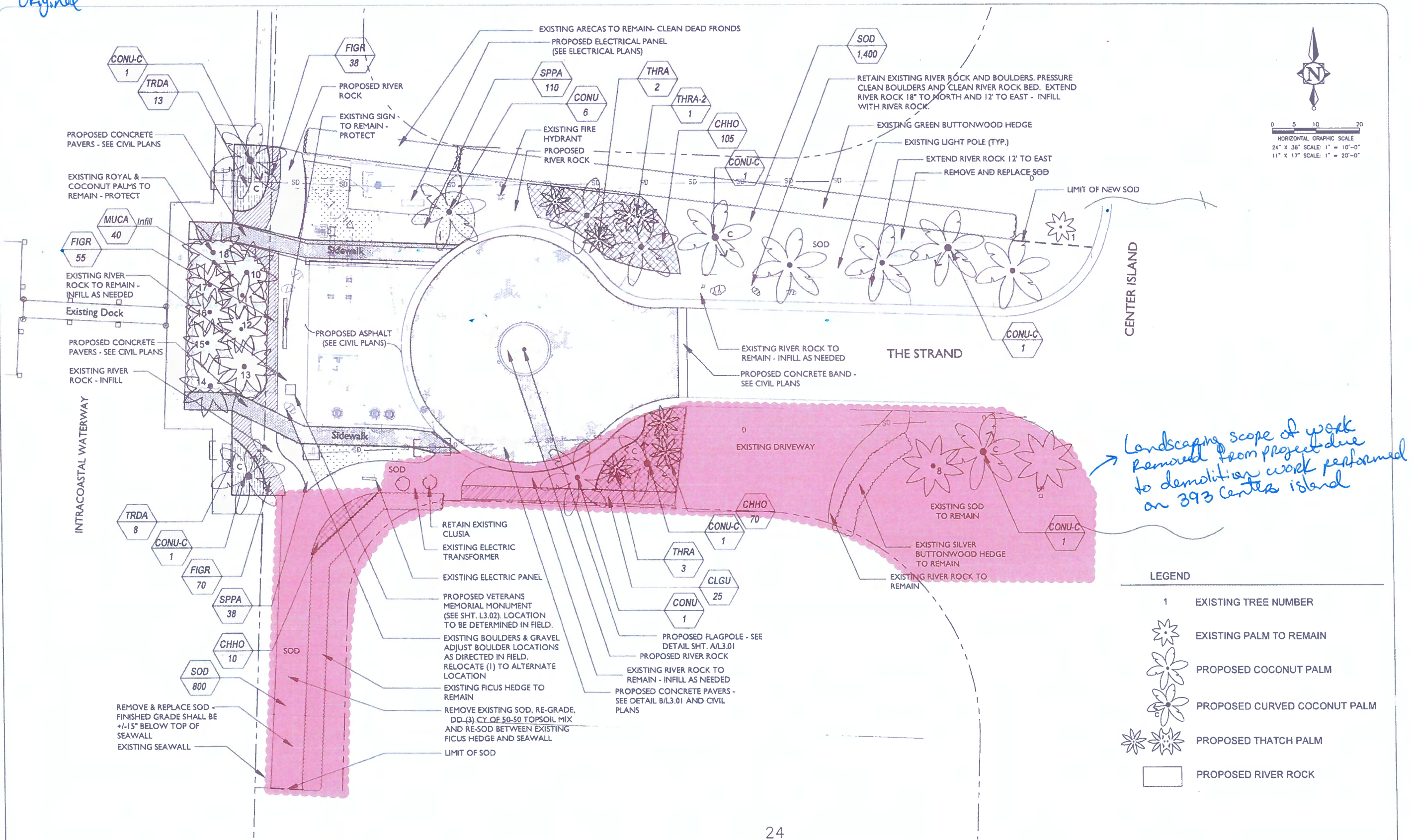
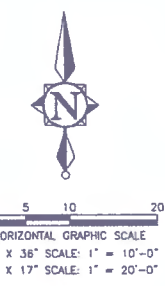

Landscaping scope of work removed from project due to demolition work performed on 393 Center Island

LEGEND

1	EXISTING TREE NUMBER
	EXISTING PALM TO REMAIN
	PROPOSED COCONUT PALM
	PROPOSED CURVED COCONUT PALM
	PROPOSED THATCH PALM
	PROPOSED RIVER ROCK

BID SET

FOR CONSTRUCTION

NO.	DATE	REVISION	BY

Date: 07/17/2020
 Designed: _____
 Drawn: _____
 Checked: _____

APPROVED BY: KATHRYN O'LEARY RICHARDS
 DATE: _____
 FLORIDA LANDSCAPE ARCHITECT NO. LA0001317

O'Leary Richards Design Associates, Inc.
 LANDSCAPE ARCHITECTURE & PLANNING
 8525 SW 92nd STREET, STE. C-118
 MIAMI, FLORIDA 33156
 (305) 596-8628
 LA CERTIFICATE NO. LC26000195

PREPARED FOR:
TOWN OF GOLDEN BEACH
 MIAMI DADE COUNTY, FLORIDA

CENTER ISLAND PUMP STATION
 LANDSCAPE PLAN

FILE NAME: L1.02.dwg
 LAST SAVED: 07/20/20 -- 1:10pm
 CAS PROJECT NUMBER
 18-2025

SHEET
L1.02

Rev1

NOTE:
 1. SECURE BATTENS WITH 2-3/4" STAINLESS STEEL BANDS TO HOLD BATTENS IN PLACE DURING PLANTING PROCESS.
 2. DO NOT NAIL BATTENS TO PALM. HEIGHT OF BATTENS SHALL BE LOCATED IN RELATION TO THE

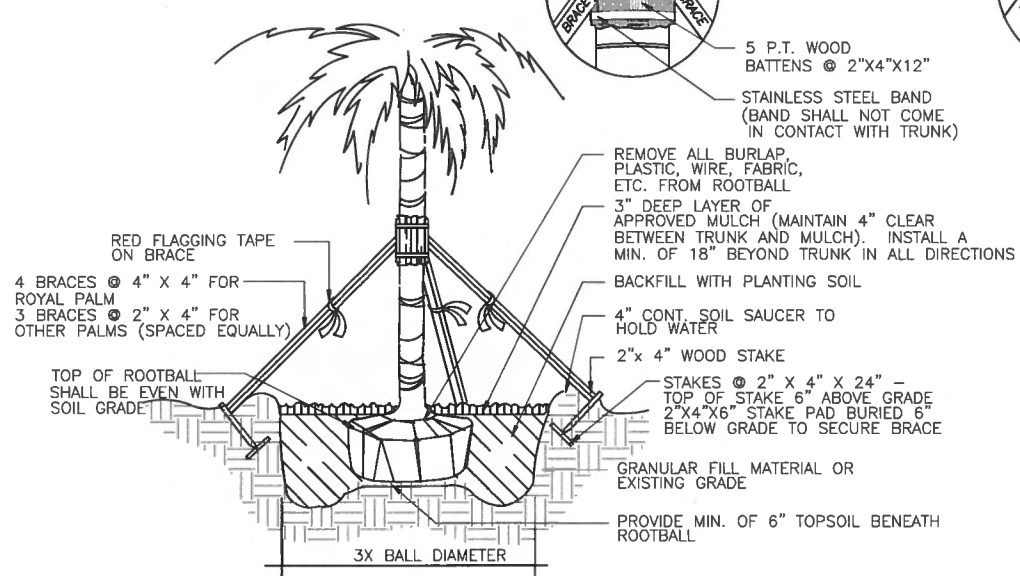

A PALM PLANTING DETAIL
 L2.01 Not to Scale

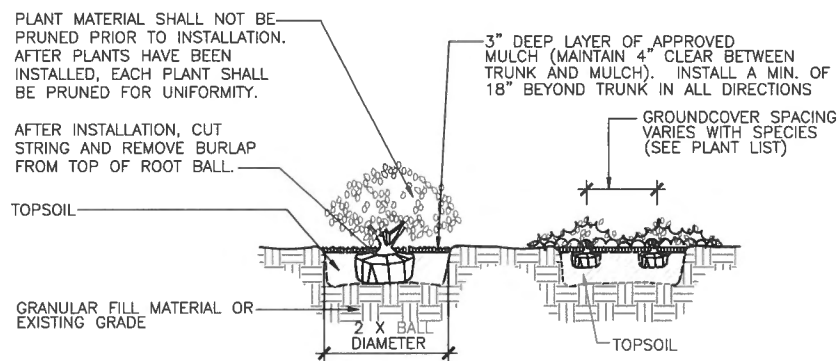

B SHRUB/GROUNDCOVER PLANTING DETAIL
 L2.01 Not to Scale

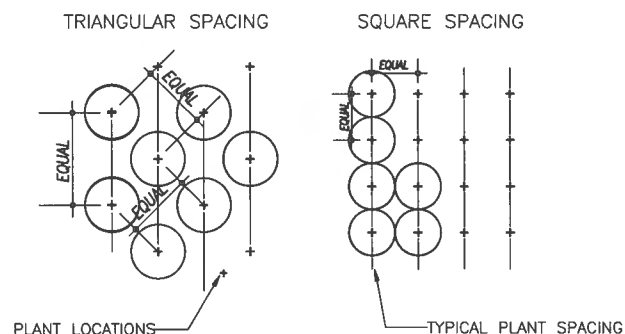

C TYPICAL PLANT SPACING
 L2.01 Not to Scale

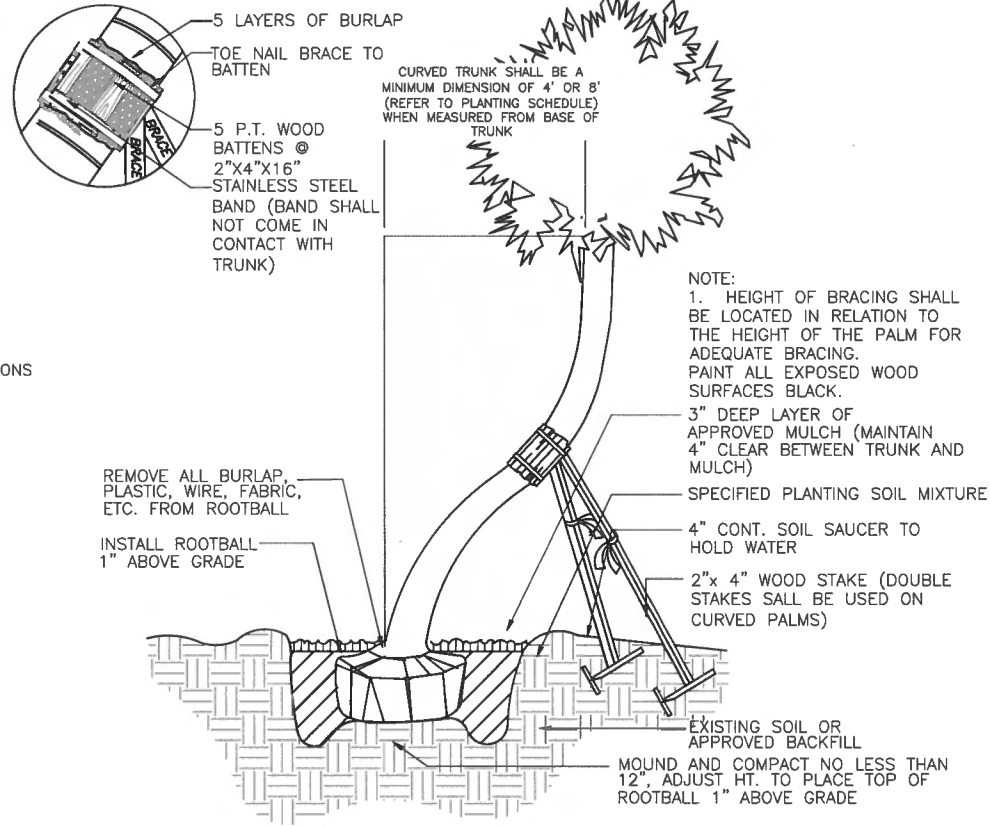

D CURVED PALM PLANTING DETAIL
 L2.01 Not to Scale

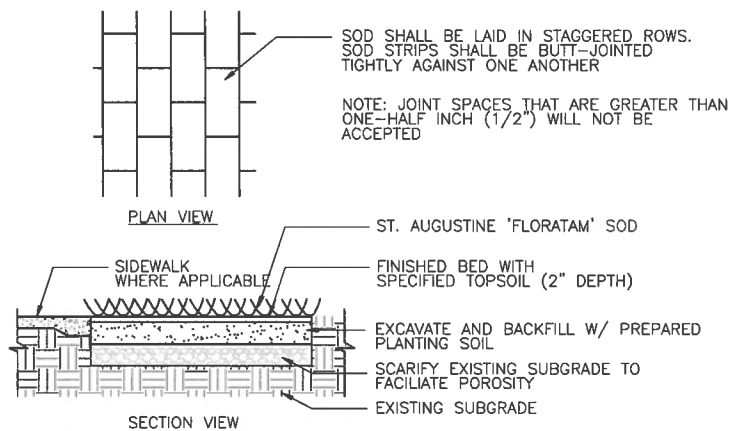

E SOD PLANTING DETAIL
 L2.01 Not to Scale

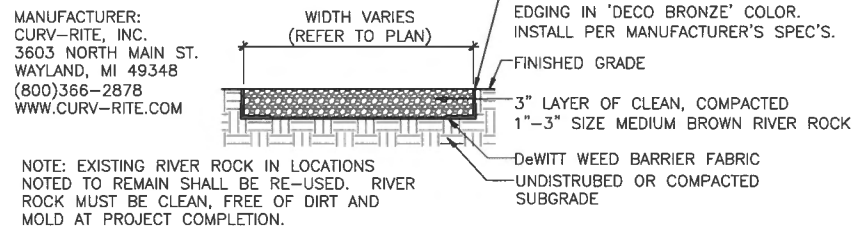

F GRAVEL & EDGING DETAIL
 L2.01 Not to Scale

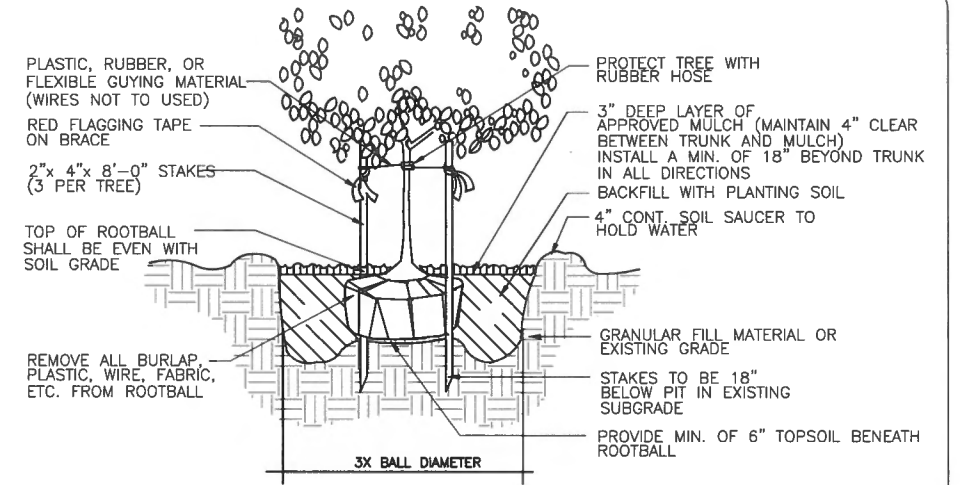

G SMALL TREE/PALM PLANTING DETAIL
 L2.01 Not to Scale

GENERAL PLANTING NOTES:

- TREES SHALL BE FLORIDA NO. 1 OR BETTER.
- TRUNK CALIPER SHALL MEET ANSIZ60 CURRENT EDITION FOR ROOTBALL SIZE.
- PRIOR TO MULCHING, LIGHTLY TAMP SOIL AROUND THE ROOT BALL IN 6" LIFTS TO BRACE TREE. DO NOT OVER COMPACT. WHEN THE PLANTING HOLE HAS BEEN BACKFILLED, POUR WATER AROUND THE ROOT BALL TO SETTLE THE SOIL.
- REMOVE PLANT CONTAINERS PRIOR TO PLANTING. IF PLANTS ARE NOT CONTAINER GROWN, REMOVE A MINIMUM OF THE TOP 1/3 BURLAP, FABRIC, OR WIRE MESH.
- ALLOW NO MORE THAN 1" OF SOIL TO COVER THE UPPERMOST ROOT ON ALL TREES. SET THE TOP OF ROOTBALL 1" - 2" ABOVE FINISH GRADE AFTER SETTLING AND SET PLUMB TO THE HORIZON.
- INSTALL GUYING WITH MINIMUM 1" WIDE NYLON OR POLYPROPYLENE STRAPS. CHECK STRAPS MONTHLY AND ADJUST AS REQUIRED TO ELIMINATE GIRDLING OF TREE. LOCATE ALL WOOD STAKES OR ANCHORS BEYOND THE EDGE OF SOIL RING IN UNDISTURBED SOIL AND LOCATED BELOW FINISHED GRADE, UNLESS OTHERWISE SPECIFIED. THE USE OF SISAL STRAPPING/ROPE IS REQUIRED AROUND THE TREE WHEN WELLINGTON TAPE IS USED TO STABILIZE THE PLANTING.

PLANT SCHEDULE

KEY	SCIENTIFIC/Common Name	UNIT	QTY	INSTALLED SIZE	NATIVE	SPACING	MAXIMUM MAINTAINED SIZE
PALMS							
CONU	<i>Cocos nucifera</i> 'Green Malayan' Gr. Malayan Coconut Palm	EA	11	8' - 12' GW, Full Heads, Certified, Heavy Trk 3 @ 8', 2 @ 10', 2 @ 12'	.	As Shown on Plans	Natural Height
CONU-C	<i>Cocos nucifera</i> 'Green Malayan' Gr. Malayan Coconut Palm-Curved	EA	7	8'-10 GW Curved Trunk with Character, 48" curve min. measured from base of trunk to front of crown	.	As Shown on Plans	Natural Height
THRA	<i>Thrinax radiata</i> Florida Thatch Palm	EA	5	6' Ht., Single Trunk, Field Grown	.	As Shown on Plans	Natural Height
THRA-2	<i>Thrinax radiata</i> Florida Thatch Palm	EA	1	6'-8' Ht., Double Trunk, Field Grown	.	As Shown on Plans	Natural Height
SHRUBS							
CHHO	<i>Chrysobalanus icaco</i> 'Horizontal' Horizontal Cocoplum	EA	220	18" Ht. X 16" Sp., 3 Gal., Full	.	24" o.c.	30" Ht.
CLGU	<i>Clusia guttifera</i> Small-leaf Clusia	EA	25	3.5' Ht. X 3' Sp., 7 Gal., Full to Ground	.	As Shown on Plans	6' Ht.
FIGR	<i>Ficus macrocarpa</i> 'Green Island' Green Island Ficus	EA	163	16" Ht. X 16" Sp., 3 Gal., Full	.	18" o.c.	24" Ht.
MUCA	<i>Muhlenbergia capillaris</i> Pink Muhly Grass	EA	40	18" Ht. X 16" Sp., 3 Gal., Full	.	24" o.c.	Natural Height
SPPA	<i>Spartina patens</i> Saltmeadow Cordgrass	EA	148	20" Ht. X 16" Sp., 3 Gal., Full	.	24" o.c.	36" Ht.
TRDA	<i>Tripsacum dactyloides</i> Fakahatchee Grass	EA	21	24" Ht. X 18" Sp., 3 Gal., Full	.	24" o.c.	Natural Height
SOD							
SOD	<i>Stenotaphrum secundatum</i> 'Floratam' St. Augustine Floratam Sod	SF	3,830	On 2" Topsoil	.		
MISCELLANEOUS							
	Medium Brown River Rock	CY	16	1"-3" River rock installed on DeWitt Weed Barrier The Bushel Stop (954) 434-1729	.		
	Edging	LF	455	Curv-rite 3000 Series Aluminum Edging, Deco Bronze Color	.		
	Boulder Relocation & Pressure Cleaning	LS	1		.		

- NOTE:
- SOD AREAS ARE AN ESTIMATE AND PROVIDED FOR REFERENCE ONLY. CONTRACTOR SHALL PROVIDE SOD AND TOPSOIL AS PER SPECIFICATIONS AS REQUIRED TO COVER AREAS SHOWN WITH SOD COMPLETELY.
 - RIVER ROCK AREAS ARE AN ESTIMATE ONLY. CONTRACTOR SHALL PROVIDE 3" OF RIVER ROCK TO ALL AREAS AS SHOWN ON THE PLANS TO COVER AREAS COMPLETELY. ADD RIVER ROCK TO AREAS THAT HAVE EXISTING RIVER ROCK TO ENSURE 3" DEPTH.
 - COST OF PLANT MATERIAL SHALL INCLUDE ALL LABOR, MATERIALS, EQUIPMENT AND INCIDENTALS IN ACCORDANCE WITH THE PLANS AND SPECIFICATIONS INCLUDING BUT NOT LIMITED TO PLANTING SOIL, UNSUITABLE SOIL REMOVAL AND DISPOSAL, SPECIAL BED PREPARATION, STAKING, MULCH, FERTILIZER, HAND WATERING, POST AND PRE-EMERGENT HERBICIDE AND WARRANTY.

FOR CONSTRUCTION

NO.	DATE	REVISION	BY

Date: 07/17/2020
 Designed: _____
 Drawn: _____
 Checked: _____

APPROVED BY: KATHRYN O'LEARY RICHARDS
 DATE: _____
 FLORIDA LANDSCAPE ARCHITECT NO. LA0001317

O'Leary Richards Design Associates, Inc.
 O'LEARY RICHARDS DESIGN
 LANDSCAPE ARCHITECTURE & PLANNING
 8525 SW 92nd STREET, STE. C-118
 MIAMI, FLORIDA 33156
 (305) 596-8628
 LA CERTIFICATE NO. LC26000195

PREPARED FOR:
 TOWN OF GOLDEN BEACH
 MIAMI DADE COUNTY, FLORIDA

CENTER ISLAND PUMP STATION
 LANDSCAPE DETAILS

FILE NAME: L2.01 & L2.02-Rev #1.dwg
 LAST SAVED: 04/11/22 - 1:07pm
 CAS PROJECT NUMBER
 18-2025

SHEET
 L2.01

Original

NOTE:
1. SECURE BATTENS WITH 2-3/4" STAINLESS STEEL BANDS TO HOLD BATTENS IN PLACE DURING PLANTING PROCESS.
2. DO NOT NAIL BATTENS TO PALM. HEIGHT OF BATTENS SHALL BE LOCATED IN RELATION TO THE

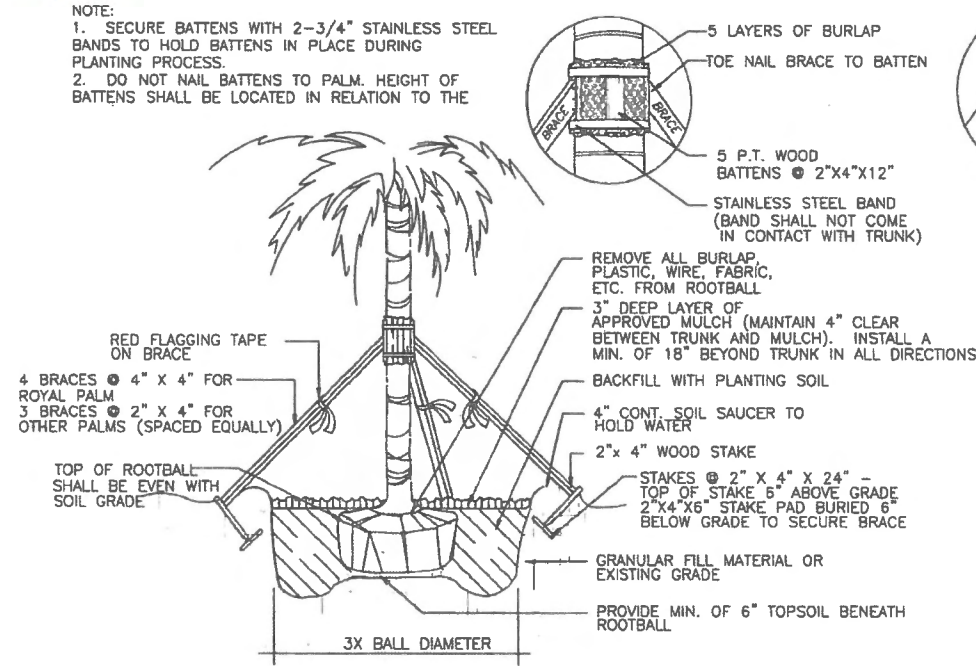

A PALM PLANTING DETAIL

L2.01

Not to Scale

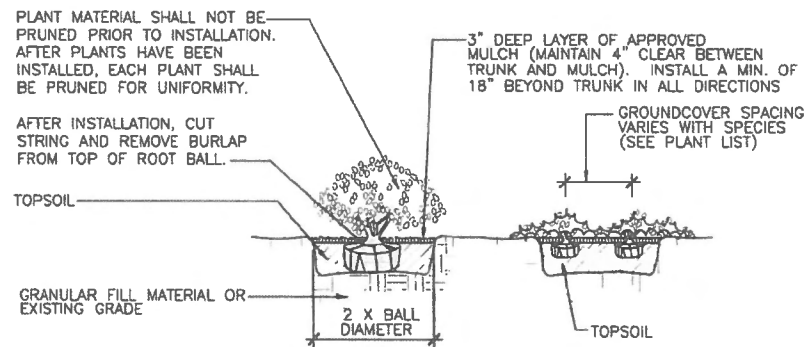

B SHRUB/GROUNDCOVER PLANTING DETAIL

L2.01

Not to Scale

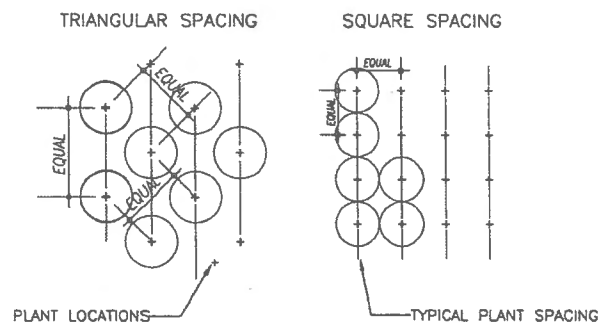

NOTE:
IN MOST CASES TRIANGULAR SPACING IS PREFERRED. USE SQUARE SPACING ONLY IN SMALL RECTILINEAR SPACES.

C TYPICAL PLANT SPACING

BI-SET

Not to Scale

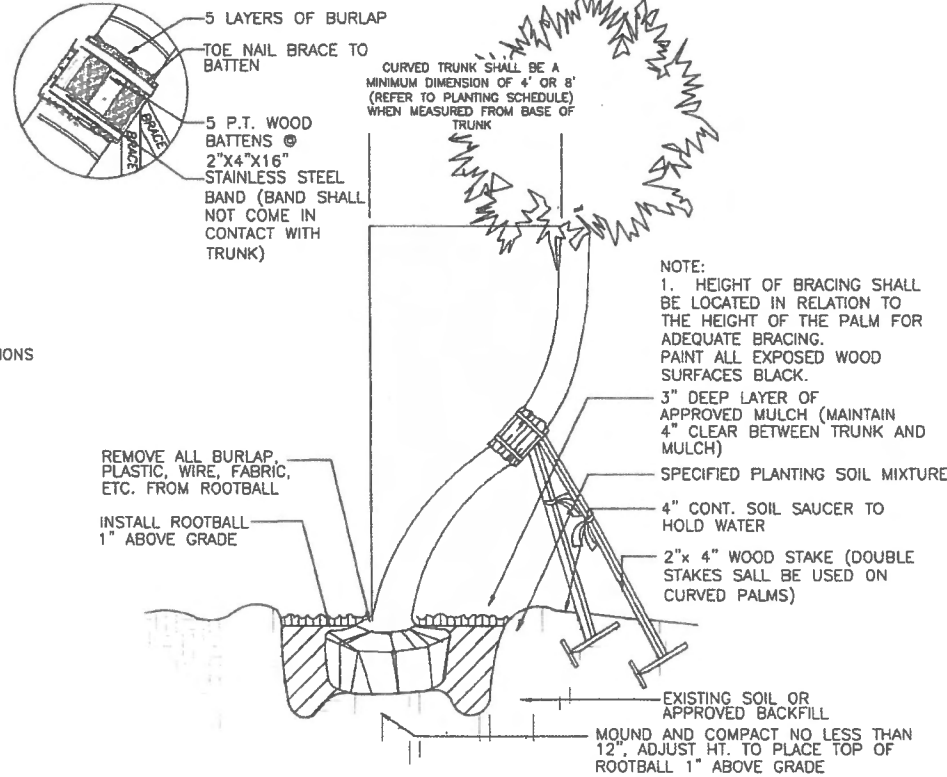

D CURVED PALM PLANTING DETAIL

L2.01

Not to Scale

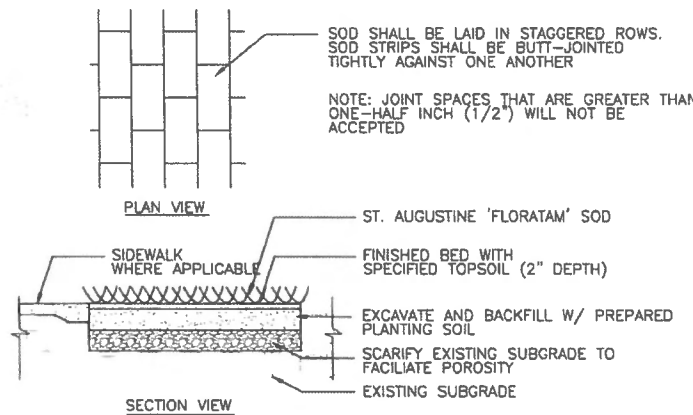

E SOD PLANTING DETAIL

L2.01

Not to Scale

MANUFACTURER:
CURV-RITE, INC.
3603 NORTH MAIN ST.
WAYLAND, MI 49348
(800)366-2878
WWW.CURV-RITE.COM

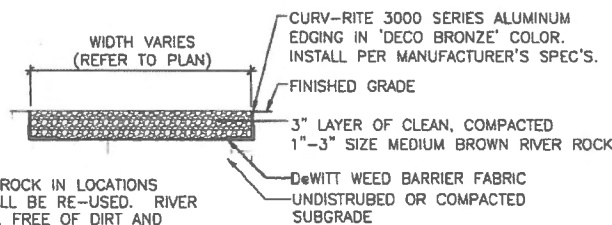

NOTE: EXISTING RIVER ROCK IN LOCATIONS NOTED TO REMAIN SHALL BE RE-USED. RIVER ROCK MUST BE CLEAN, FREE OF DIRT AND MOLD AT PROJECT COMPLETION.

F GRAVEL & EDGING DETAIL

L2.01

Not to Scale

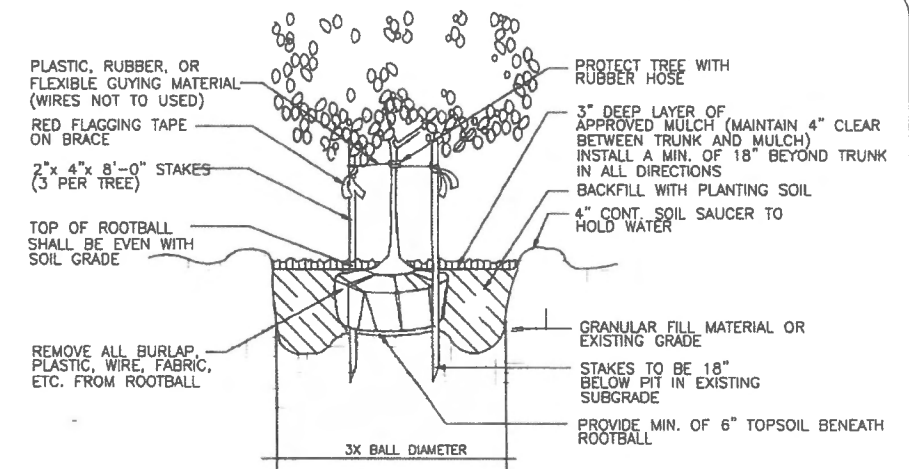

G SMALL TREE/PALM PLANTING DETAIL

L2.01

Not to Scale

GENERAL PLANTING NOTES:

- TREES SHALL BE FLORIDA NO. 1 OR BETTER.
- TRUNK CALIPER SHALL MEET ANSIZ60 CURRENT EDITION FOR ROOTBALL SIZE.
- PRIOR TO MULCHING, LIGHTLY TAMP SOIL AROUND THE ROOT BALL IN 6" LIFTS TO BRACE TREE. DO NOT OVER COMPACT. WHEN THE PLANTING HOLE HAS BEEN BACKFILLED, POUR WATER AROUND THE ROOT BALL TO SETTLE THE SOIL.
- REMOVE PLANT CONTAINERS PRIOR TO PLANTING. IF PLANTS ARE NOT CONTAINER GROWN, REMOVE A MINIMUM OF THE TOP 1/3 BURLAP, FABRIC, OR WIRE MESH.
- ALLOW NO MORE THAN 1" OF SOIL TO COVER THE UPPERMOST ROOT ON ALL TREES. SET THE TOP OF ROOTBALL 1" - 2" ABOVE FINISH GRADE AFTER SETTLING AND SET PLUMB TO THE HORIZON.
- INSTALL GUYING WITH MINIMUM 1" WIDE NYLON OR POLYPROPYLENE STRAPS. CHECK STRAPS MONTHLY AND ADJUST AS REQUIRED TO ELIMINATE GIRDLING OF TREE. LOCATE ALL WOOD STAKES OR ANCHORS BEYOND THE EDGE OF SOIL RING IN UNDISTURBED SOIL AND LOCATED BELOW FINISHED GRADE, UNLESS OTHERWISE SPECIFIED. THE USE OF SISAL STRAPPING/ROPE IS REQUIRED AROUND THE TREE WHEN WELLINGTON TAPE IS USED TO STABILIZE THE PLANTING.

PLANT SCHEDULE

KEY	SCIENTIFIC/Common Name	UNIT	QTY	INSTALLED SIZE	NATIVE	SPACING	MAXIMUM MAINTAINED SIZE
PALMS							
CONU	<i>Cocos nucifera</i> 'Green Malayan' Gr. Malayan Coconut Palm	EA	7	8' - 12' GW, Full Heads, Certified, Heavy Trk 3 @ 6', 2 @ 10', 2 @ 12'	*	As Shown on Plans	Natural Height
CONU-C	<i>Cocos nucifera</i> 'Green Malayan' Gr. Malayan Coconut Palm-Curved	EA	6	8-10 GW Curved Trunk with Character, 48" curve min. measured from base of trunk to front of crown	*	As Shown on Plans	Natural Height
THRA	<i>Thrinax radiata</i> Florida Thatch Palm	EA	5	6' Ht. Single Trunk, Field Grown	*	As Shown on Plans	Natural Height
THRA-2	<i>Thrinax radiata</i> Florida Thatch Palm	EA	1	6'-8' Ht. Double Trunk, Field Grown	*	As Shown on Plans	Natural Height
SHRUBS							
CHHO	<i>Chrysobalanus icaco</i> 'Horizontal' Horizontal Coccolup	EA	185	18" Ht X 16" Sp., 3 Gal., Full	*	24" o.c.	30" Ht.
CLGU	<i>Clusia guttifera</i> Small-leaf Clusia	EA	25	3.5' Ht X 3' Sp., 7 Gal., Full to Ground	*	As Shown on Plans	6" Ht.
FIGR	<i>Ficus macrocarpa</i> 'Green Island' Green Island Ficus	EA	163	16" Ht X 16" Sp., 3 Gal., Full	*	18" o.c.	24" Ht.
MUCA	<i>Muhlenbergia capillaris</i> Pink Muhly Grass	EA	40	18" Ht X 16" Sp., 3 Gal., Full	*	24" o.c.	Natural Height
SPPA	<i>Spartina patens</i> Saltmeadow Cordgrass	EA	148	20" Ht X 16" Sp., 3 Gal., Full	*	24" o.c.	36" Ht.
TRDA	<i>Tripsacum dactyloides</i> Fakahatchee Grass	EA	21	24" Ht X 16" Sp., 3 Gal., Full	*	24" o.c.	Natural Height
SOD							
SOD	<i>Stenotaphrum secundatum</i> 'Floratum' St. Augustine Floratum Sod	SF	2200	On 2" Topsoil			
MISCELLANEOUS							
	Medium Brown River Rock	CY	12	1"-3" River rock installed on DeWitt Weed Barrier - The Bushel Stop (854) 434-1729			
	Edging	LF	375	Curv-rite 3000 Series Aluminum Edging, Deco Bronze Color			
	Boulder Relocation & Pressure Cleaning	LS	1				

NOTE:

- SOD AREAS ARE AN ESTIMATE AND PROVIDED FOR REFERENCE ONLY. CONTRACTOR SHALL PROVIDE SOD AND TOPSOIL AS PER SPECIFICATIONS AS REQUIRED TO COVER AREAS SHOWN WITH SOD COMPLETELY.
- RIVER ROCK AREAS ARE AN ESTIMATE ONLY. CONTRACTOR SHALL PROVIDE 3" OF RIVER ROCK TO ALL AREAS AS SHOWN ON THE PLANS TO COVER AREAS COMPLETELY. ADD RIVER ROCK TO AREAS THAT HAVE EXISTING RIVER ROCK TO ENSURE 3" DEPTH.
- COST OF PLANT MATERIAL SHALL INCLUDE ALL LABOR, MATERIALS, EQUIPMENT AND INCIDENTALS IN ACCORDANCE WITH THE PLANS AND SPECIFICATIONS INCLUDING BUT NOT LIMITED TO PLANTING SOIL, UNSUITABLE SOIL REMOVAL AND DISPOSAL, SPECIAL BED PREPARATION, STAKING, MULCH, FERTILIZER, HAND WATERING, POST AND PRE-EMERGENT HERBICIDE AND WARRANTY.

FOR CONSTRUCTION

NO	DATE	REVISION	BY

Date: 07/17/2020
Designed: _____
Drawn: _____
Checked: _____

APPROVED BY: KATHRYN O'LEARY RICHARDS
DATE: _____
FLORIDA LANDSCAPE ARCHITECT NO. LA0001317

O'Leary Richards Design Associates, Inc.
O'LEARY RICHARDS DESIGN
LANDSCAPE ARCHITECTURE & PLANNING
8525 SW 92nd STREET, STE. C-118
MIAMI, FLORIDA 33156
(305) 596-6628
LA CERTIFICATE NO. LC26000195

PREPARED FOR:
TOWN OF GOLDEN BEACH
MIAMI DADE COUNTY, FLORIDA

CENTER ISLAND PUMP STATION
LANDSCAPE DETAILS

FILE NAME: L2.01 & L2.02.dwg
LAST SAVED: 07/20/20 - 10:17am
CAS PROJECT NUMBER
18-2025

SHEET
L2.01